

# STATE OF ALASKA

## DEPARTMENT OF TRANSPORTATION AND PUBLIC FACILITIES

### PROPOSED HIGHWAY PROJECT

# HSIP: CR GUARDRAIL INVENTORY AND UPGRADE

## PROJECT NO. 001665/CFHWY00564

### CLEARING, GRUBBING, GRADING & ROADSIDE HARDWARE

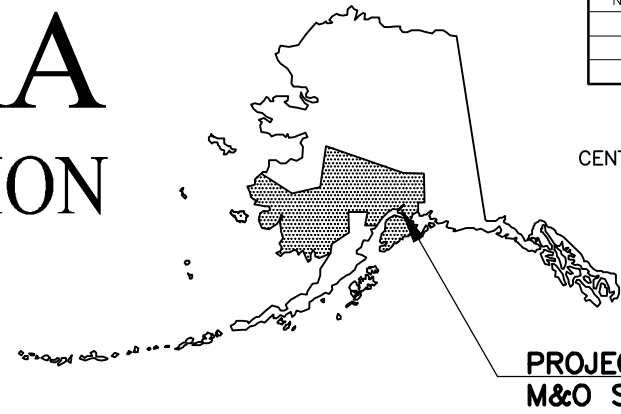

NO.	DATE	REVISION	STATE	PROJECT DESIGNATION	YEAR	SHEET NO.	TOTAL SHEETS
			ALASKA	001665/CFHWY00564	2022	A1	A3
ROUTE ID	2281321X000	MILEPOINT	4.350 - 7.680				
LATITUDE	61.147763	LONGITUDE	-149.887329				
ROUTE ID	10600001000	MILEPOINT	0.000 - 31.000				
LATITUDE	61.348434	LONGITUDE	-149.554149				
ROUTE ID	2361000X000	MILEPOINT	0.000 - 11.320				
LATITUDE	61.487907	LONGITUDE	-148.901369				
ROUTE ID	2281235X000	MILEPOINT	0.180 - 1.700				
LATITUDE	61.173497	LONGITUDE	-149.934757				
ROUTE ID	1021005X000	MILEPOINT	0.000 - 5.180				
LATITUDE	60.794811	LONGITUDE	-148.908705				
ROUTE ID	1020000X000	MILEPOINT	89.700 - 114.000				
LATITUDE	60.984357	LONGITUDE	-149.530739				

DESIGNED BY  
CHECKED BY  
DRAFTED BY

SCALE  
N/A

TIME  
12:06 PM

DATE  
3/4/2022

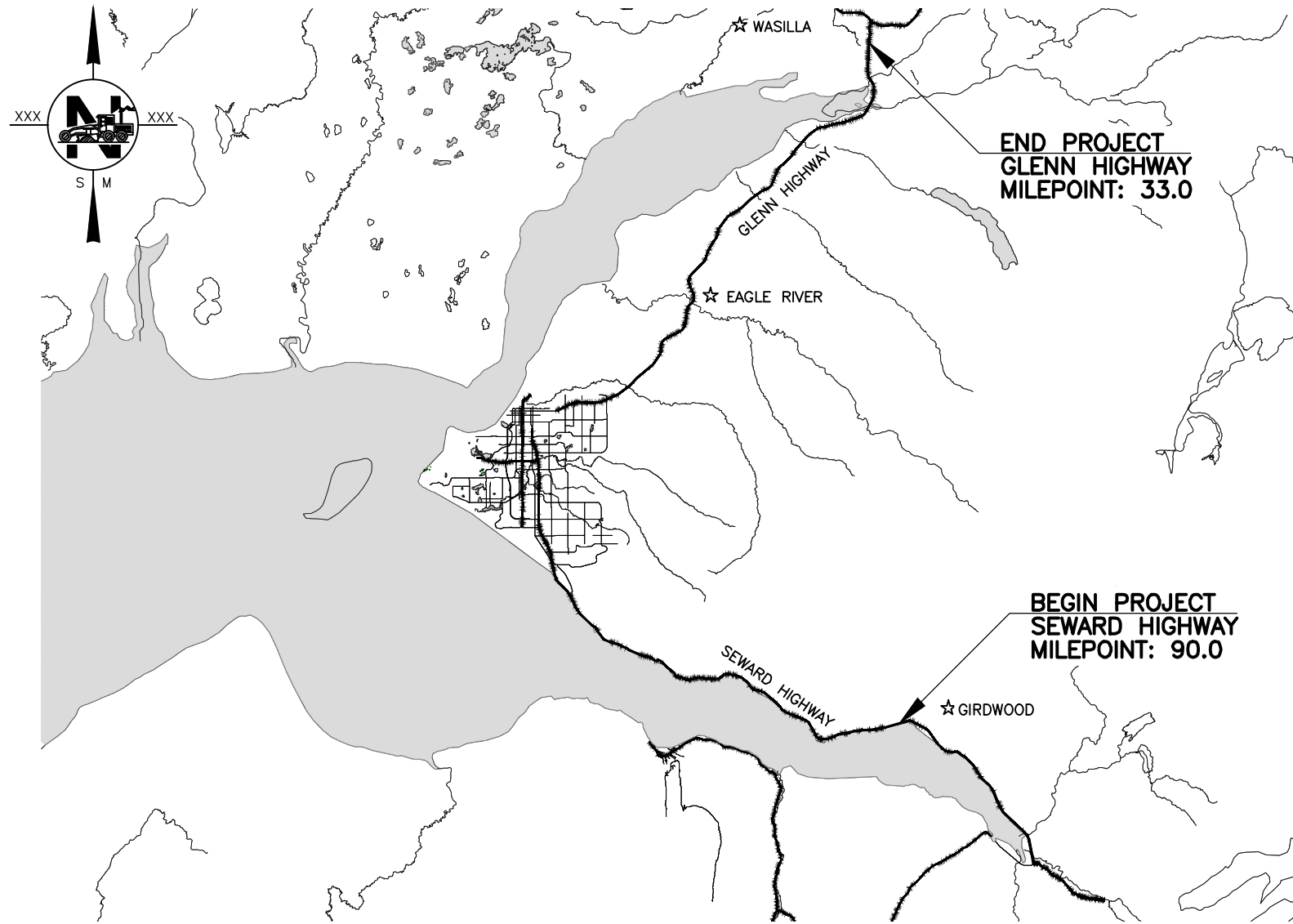

PROJECT SUMMARY	
ROADWAY NAME	LENGTH
C STREET	3.33 MILES
GLENN HIGHWAY	31.00 MILES
KNIK RIVER ROAD	12.00 MILES
INTERNATIONAL AIRPORT ROAD	1.52 MILES
PORTAGE GLACER ROAD	5.18 MILES
SEWARD HIGHWAY	24.30 MILES

DESIGN DESIGNATIONS	
ROADWAY NAME	DESIGN SPEED
C STREET	55 MPH
GLENN HIGHWAY	55-65 MPH
KNIK RIVER ROAD	55 MPH
INTERNATIONAL AIRPORT ROAD	50 MPH
PORTAGE GLACER ROAD	55 MPH
SEWARD HIGHWAY	55 MPH

PLANS DEVELOPED BY: LOUNSBURY & ASSOCIATES

STATE OF ALASKA  
DEPARTMENT OF TRANSPORTATION & PUBLIC FACILITIES  
4111 AVIATION AVENUE, ANCHORAGE, AK 99502  
(907)269-0590

APPROVED:

REGIONAL PRECONSTRUCTION ENGINEER \_\_\_\_\_ DATE \_\_\_\_\_

CONCUR:

REGIONAL CONSTRUCTION ENGINEER \_\_\_\_\_ DATE \_\_\_\_\_

DRAWING LOCATION  
D:\PWISFILE\DM504400\PL-20-001 A1 COVER ANC.DWG

PLANS DEVELOPED BY: LOUNSBURY & ASSOCIATES ADDRESS: 3230 C ST., SUITE 201, ANCHORAGE AK 99503 PHONE: (907) 272-5451 CERTIFICATE OF AUTHORIZATION NUMBER: AECC391  
 FILE ID: P:\WISEFILE\DWG\04400\PL-20-001 A2 INDEX ANCH.DWG DATE/TIME: 3/4/2022 1:52 PM

**GENERAL NOTES:**

1. ALL CONSTRUCTION SHALL BE CONTAINED WITHIN THE RIGHT-OF-WAY. NO EXCESS MATERIAL SHALL BE DISPOSED OF WITHIN THE RIGHT-OF-WAY, UNLESS SPECIFICALLY CALLED FOR IN THE PLANS OR DIRECTED BY THE ENGINEER.
2. THE ROW LINES SHOWN ARE FROM RECORD MAPPING FROM DOT&PF AND HAVE BEEN INSERTED INTO THE PLANS BY SCANNED PDF AND ARE APPROXIMATE.
3. ALL PAVEMENT CUTS SHALL BE MADE WITH A SAW OR ALTERNATE METHOD APPROVED BY THE ENGINEER.
4. CLEARING LIMITS SHALL BE 10 FEET BEYOND SLOPE CATCH POINTS OR 10 FEET INSIDE THE RIGHT-OF-WAY LINE, WHICHEVER IS LESS.
5. PLACE 4" TOPSOIL AND SEED ANY AREAS DISTURBED BY CONSTRUCTION AND AS DIRECTED BY THE ENGINEER.
6. THE EXISTING INFORMATION SHOWN IN THE PLANS IS FROM AS-BUILTS AND HAS BEEN PARTIALLY FIELD VERIFIED. FIELD CONDITIONS MAY NOT BE ACCURATELY REPRESENTED AND/OR MAY HAVE CHANGED. ADJUST INSTALLATIONS AS DIRECTED BY THE ENGINEER.
7. FOR PARALLEL GUARDRAIL TERMINALS, USE AN END OFFSET OF 2 FEET.
8. UTILITIES MAY BE PRESENT IN THE PROJECT CORRIDOR BUT ARE NOT SHOWN ON THE PLANS. LOCATE AND PROTECT FROM CONSTRUCTION DAMAGE ALL EXISTING UTILITIES WITHIN THE PROJECT LIMITS PRIOR TO ANY GROUND DISTURBING ACTIVITY. CONTACT THE DIGLINE (1-800-478-3121) OR THE UTILITY COMPANIES FOR LOCATES.
9. CONTRACTOR MUST HAVE MATERIALS ON HAND TO COMPLETE THE LOCATION INSTALLATION BEFORE REMOVING GUARDRAIL.
10. THIS SHEET DEPICTS ONLY THOSE SITES THAT REQUIRE GRADING OR SITE WORK BEYOND WHAT IS CONVEYED IN THE STANDARD DETAILS. ADDITIONAL SITES REQUIRING WORK ARE DESCRIBED IN THE "D-SERIES" PROJECT SUMMARY TABLES.

NO.	DATE	REVISION	STATE	PROJECT DESIGNATION	YEAR	SHEET NO.	TOTAL SHEETS
			ALASKA	0001665/CFHWY00564	2022	A2	A3

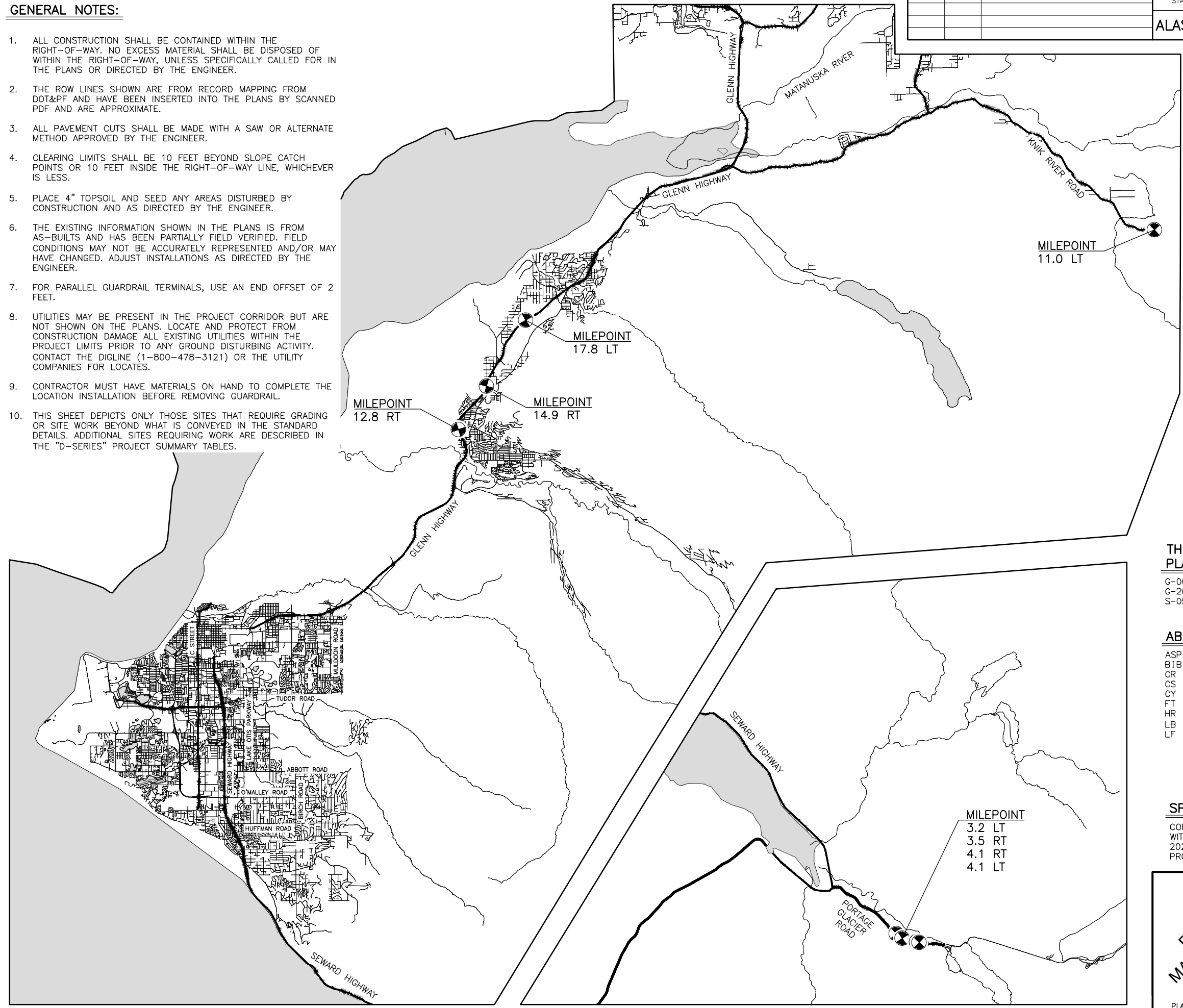

SITE INDEX		
ROADWAY NAME	MILE POINT	SHEET NO.
GLENN HIGHWAY	12.8 RT	G1
	14.9 RT	
	17.8 LT	
PORTAGE GLACIER	3.2 LT	G2
	3.5 RT	
	4.1 RT	
	4.1 LT	
KNIK RIVER ROAD	11.0 LT	G3

INDEX	
SHEET NO.	DESCRIPTION
SHEET NO.	TITLE SHEET
A2	SHEET LAYOUT, INDEX, AND GENERAL NOTES
A3	LEGEND
B1	TYPICAL SECTIONS
C1	ESTIMATE OF QUANTITIES
D1-D6	SUMMARY TABLES
G1-G3	GRADING PLANS

**THE FOLLOWING ALASKA STANDARD PLANS APPLY TO THIS PROJECT:**  
 G-00.05, G-05.11S, G-05.11W, G-10.20, G-11.01, G-16.00, G-20.12, G-26.00, G-29.00, G-32.02, S-05.02, S-30.05

**ABBREVIATIONS:**

ASP ALASKA STANDARD PLAN	LS LUMP SUM
BIB BURIED IN BACKSLOPE	ML MAINLINE
CR CENTRAL REGION	MP MILEPOST
CS CONTINGENT SUM	MPT MILEPOINT
CY CUBIC YARD	NO NUMBER, NUMBERING
FT FOOT OR FEET	R# RAMP QUADRANT
HR HOUR	Q# BRIDGE QUADRANT
LB POUND(S)	ROW RIGHT-OF-WAY
LF LINEAR FEET	SRG SHORT RADIUS GUARDRAIL
	SY SQUARE YARD
	TYP TYPICAL

**SPECIFICATION:**  
 CONSTRUCT THE IMPROVEMENTS COVERED BY THESE PLANS IN ACCORDANCE WITH THE ALASKA DEPARTMENT OF TRANSPORTATION AND PUBLIC FACILITIES 2020 STANDARD SPECIFICATIONS FOR HIGHWAY CONSTRUCTION AND THE PROJECT SPECIAL PROVISIONS.

**DRAFT**  
MARCH, 4 2022

STATE OF ALASKA  
DEPARTMENT OF TRANSPORTATION  
AND PUBLIC FACILITIES

**HSIP: CR GUARDRAIL INVENTORY  
AND UPGRADE**

SHEET LAYOUT, INDEX,  
AND GENERAL NOTES

PLANS DEVELOPED BY:  
LOUNSBURY & ASSOCIATES INC.

PLANS DEVELOPED BY: LOUNSBURY & ASSOCIATES ADDRESS: 3230 C ST., SUITE 201, ANCHORAGE AK 99503 PHONE: (907) 272-5451 CERTIFICATE OF AUTHORIZATION NUMBER: AEC391  
 FILE ID: \P\W\FILE\DWG\04\00\PL-20-001 A3 SHEET ANC.DWG DATE/TIME: 3/4/2022 1:53 PM [LAYOUT] [DESIGNED] [SA] [CHECKED] [JT] [DRAFTED] [DU]

NO.	DATE	REVISION	STATE	PROJECT DESIGNATION	YEAR	SHEET NO.	TOTAL SHEETS
			ALASKA	0001665/CFHWY00564	2022	A3	A3

	EXISTING	PROPOSED
EDGE OF PAVEMENT		
LIMIT OF CUT SLOPE & FILL SLOPE		
GRAVEL EDGE		
SIDEWALK AND PATH/TRAIL		
CONCRETE CURB & GUTTER		
CONCRETE CURB CUT		
PARALLEL CURB RAMP		
PERPENDICULAR CURB RAMP		
UNIDIRECTIONAL CURB RAMP & MID-BLOCK CURB RAMP		
DETECTABLE WARNING TILE		
BRIDGE		
TUNNEL		
GUARDRAIL		
END & PARALLEL END SECTIONS		
ROADWAY OBLITERATION		
FENCE		
STONE FENCE		
NOISE BARRIER		
RETAINING WALL		
HEADWALL & WINGWALL		
BOTTOM OF DITCH		
SPECIAL DITCH		
FLAT BOTTOM DITCH		
BERM		
RIPRAP		
BOULDER OR BOULDERS		
PRIVATE SIGN, MAILBOX		
POST, BOLLARD		
GRADING BREAK LINE		

	EXISTING	PROPOSED
STORM DRAIN		
STORM DRAIN MANHOLE, CLEANOUT		
CURB INLET CATCH BASIN		
FIELD INLET CATCH BASIN		
PIPE CULVERT WITH END SECTION		
SANITARY SEWER		
SANITARY SEWER MANHOLE, CLEANOUT		
SEPTIC VENT, SEWER SERVICE CONNECTION		
WATER		
FIRE HYDRANT, VALVE OR RISER		
WELL, WATER SERVICE CONNECTION		
NATURAL GAS		
OIL OR GASOLINE PIPELINE		
TANKS (ABOVE GROUND, UNDERGROUND)		
ELECTRIC		
UTILITY POLE, POLE WITH LUMINAIRE		
GUY POLE, GUY WIRE ANCHOR		
TRANSMISSION TOWER (WOOD, STEEL)		
ELECTRIC PEDESTAL, TRANSFORMER		
ELECTRIC MANHOLE, METER		
ELECTRIC OUTLET, LANDSCAPE LIGHT		
TELEPHONE		
TELEPHONE MANHOLE, PEDESTAL		
FIBER OPTIC		
FIBER OPTIC MANHOLE		
CABLE TV		
CABLE TV PEDESTAL, SATELLITE DISH		
UNDERGROUND DUCT, UTILIDOR (ELECTRIC, TELEPHONE, FIBER OPTIC)		
VENT		

	EXISTING	PROPOSED
LOAD CENTER		
STATE TRAFFIC, MOA TRAFFIC, & BEACON CONTROLLER		
ARROW INDICATES DOOR LOCATION		
TYPE 1A, II, III, IV JUNCTION BOX		
FIBER OPTIC VAULT		
ELECTROLIER		
HIGHTOWER		
SIGNAL POLE WITH MASTARM		
PEDESTRIAN PUSH BUTTON & SIGNAL		
VEHICULAR SIGNAL		
VEHICULAR SIGNAL LEFT & RIGHT		
OPTICAL, CAMERA, RADAR, AND GPS DETECTOR		
LOOP DETECTOR		
COMMUNICATION ANTENNA		
MASTARM BEACON		
RURAL & SCHOOL ZONE BEACON		
LOOP DETECTOR CONDUIT		
SIGNAL CONDUIT		
LIGHTING CONDUIT		
SIGNAL & LIGHTING CONDUIT		
CONDUIT BORING		
CONDUIT SIZE IN INCHES		
INTERCONNECT		
SIGN POST		

	EXISTING	PROPOSED
TRAFFIC PROJECT CENTERLINE		
8" & 4" WHITE SOLID STRIPE		
4" WHITE SKIP STRIPE		
10' STRIPES AND 30' SPACES		
8" WHITE LANE GUIDE SKIP		
LANE CONTINUATION OR TURN SKIP		
1' STRIPES AND 3' SPACES		
8" & 4" YELLOW SOLID STRIPE		
4" YELLOW SKIP STRIPE		
10' STRIPES AND 30' SPACES		
STRIPING CHANGE STATION INTERVAL		
2' CROSSWALK OR STOPBAR		
LADDER CROSSWALK LAYOUT		
2' WIDE RUNGS WITH 2' SPACES		
ALIGNED TO AVOID TIRE PATHS		
TYPICAL PAINTED MEDIAN		

	RECOVERED	SET THIS PROJECT
FEDERAL GOV'T SURVEY MONUMENT		
GOV'T CONTROL STATION		
PRIMARY MONUMENT (BRASS/AL CAP)		
MISC SECONDARY CORNER		
PRIMARY CENTERLINE MONUMENT		
SECONDARY CENTERLINE MONUMENT		
RANDOM CONTROL MONUMENT		
PRIMARY GPS CONTROL POINT		
HORIZONTAL CONTROL POINT		
SECONDARY CONTROL POINT		
VERTICAL BENCHMARK		
TEMPORARY BENCHMARK		
TOWNSHIP AND RANGE LINES		
SECTION LINE		
1/4 SECTION LINE		
1/16 SECTION LINE		
CORPORATE or CITY LIMITS		
EXISTING RIGHT-OF-WAY		
RIGHT-OF-WAY OR EASEMENT REQUIRED		
PROJECT RIGHT-OF-WAY LINE		
EXISTING RIGHT-OF-WAY EASEMENT		
EXISTING PROPERTY LINE		
CONTROLLED ACCESS LINE		
EXISTING UTILITY EASEMENT		
PROPOSED UTILITY EASEMENT		
EXISTING CENTERLINE		
RAILROAD CENTERLINE		
TEMPORARY CONSTRUCTION EASEMENT		
TEMPORARY CONSTRUCTION PERMIT		

	EXISTING	PROPOSED
LAKE OR POND, WETLANDS		
TREE (CONIFER/DECIDUOUS)		
TREELINE (EDGE OF VEGETATION)		
PLANTER		
BUILDING OR FOUNDATION		
CONTOUR, MAJOR OR MINOR		
DRAINAGE FLOW		
CREEK (CENTERLINE)		
RIVER (EDGE OF WATER)		

DRAFT

MARCH, 4 2022

STATE OF ALASKA  
DEPARTMENT OF TRANSPORTATION  
AND PUBLIC FACILITIES

HSIP: CR GUARDRAIL INVENTORY  
AND UPGRADE

LEGEND

PLANS DEVELOPED BY: LOUNSBURY & ASSOCIATES INC.

NO.	DATE	REVISION	STATE	PROJECT DESIGNATION	YEAR	SHEET NO.	TOTAL SHEETS
			ALASKA	0001665/CFHWY00564	2022	B1	B1

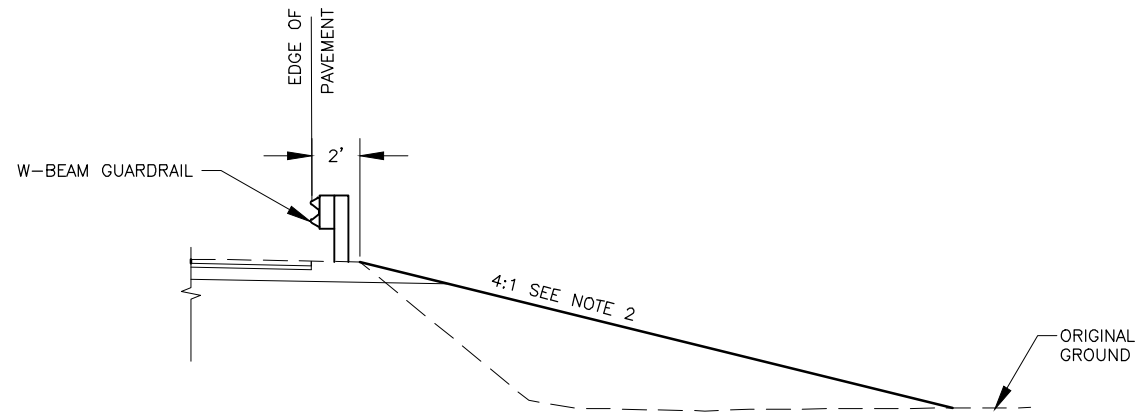

**GUARDRAIL EMBANKMENT SLOPE**

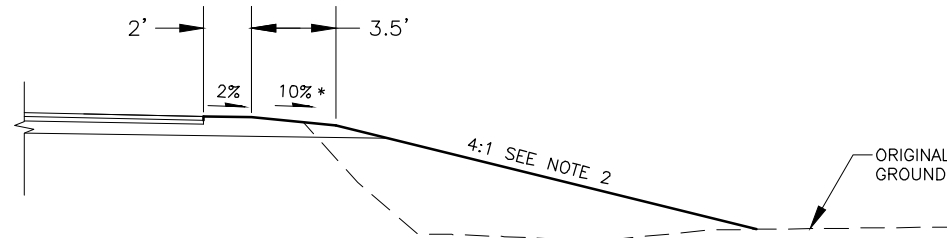

**END TERMINAL FLARE WIDENING**

USE ALTERNATE WIDENING AS SHOWN  
IN ASPG 20.12

* SLOPE EXCEPTION TABLE		
ROUTE	MPT	WIDENING SLOPE EXCEPTION (%)
GLENN HIGHWAY	1.3	5
	16.7	8
	22.6R	2
	23.3L	9
	24.2L	8
PORTAGE GLACIER ROAD	2.9	9

**NOTE:**

1. WITHIN TWO (2) DAYS AFTER PAVING, PLACE AGGREGATE BASE COURSE, GRADING D-1 AGAINST PAVEMENT EDGE TO ENSURE THERE IS NO VERTICAL DROP AT THE EDGE OF PAVEMENT. USE APPROVED TRAFFIC CONTROL DEVICES IN THE INTERIM.
2. SLOPES SHALL BE 4:1 UNLESS OTHERWISE SHOWN. SEE GRADING SHEETS.

**DRAFT**  
**MARCH, 4 2022**

STATE OF ALASKA  
DEPARTMENT OF TRANSPORTATION  
AND PUBLIC FACILITIES

**HSIP: CR GUARDRAIL INVENTORY  
AND UPGRADE**

TYPICAL SECTIONS

PLANS DEVELOPED BY:  
LOUNSBURY & ASSOCIATES INC.

PLANS DEVELOPED BY: LOUNSBURY & ASSOCIATES ADDRESS: 3230 C ST., SUITE 201, ANCHORAGE AK 99503 PHONE: (907) 272-5451 DATE/TIME: 3/4/2022 1:53 PM CERTIFICATE OF AUTHORIZATION NUMBER: AECC391 FILE ID: \P\W\B\FILE\DM504400\PL-20-001 B SHEETS ANC.DWG

DU DRAFTED JT CHECKED SA DESIGNED LAYOUT

PLANS DEVELOPED BY: LOUNSBURY & ASSOCIATES ADDRESS: 3230 C ST., SUITE 201, ANCHORAGE AK 99503 PHONE: (907) 272-5451 DATE/TIME: 3/4/2022 1:53 PM CERTIFICATE OF AUTHORIZATION NUMBER: AECC391 FILE ID: \P\W\SE\FILE\DWG\04400\PL-20-001 C SHEETS ANC.DWG

NO.	DATE	REVISION	STATE	PROJECT DESIGNATION	YEAR	SHEET NO.	TOTAL SHEETS
			ALASKA	0001665/CFHWY00564	2022	C1	C1

ESTIMATE OF QUANTITIES			
ITEM NO.	ITEM DESCRIPTION	PAY UNIT	QUANTITY
201.0009.0000	CLEARING AND GRUBBING	LS	ALL REQ'D
203.0003.0000	UNCLASSIFIED EXCAVATION	CY	3
203.0006.000A	BORROW, TYPE A	TON	430
301.0001.00D1	AGGREGATE BASE COURSE, GRADING D-1	TON	90
401.0001.002A	HMA, TYPE II; CLASS A	TON	50
401.0004.5228	ASPHALT BINDER, GRADE PG 52-28	TON	3
606.0001.0000	W-BEAM GUARDRAIL	LF	129,200
606.0006.0000	REMOVING AND DISPOSING OF GUARDRAIL	LF	126,025
606.0009.0000	SHORT RADIUS GUARDRAIL	EACH	9
606.0013.0000	PARALLEL GUARDRAIL TERMINAL	EACH	192
606.0014.0000	BURIED IN BACKSLOPE GUARDRAIL TERMINAL	EACH	2
606.0016.0000	TRANSITION RAIL	EACH	57
606.2007.000C	CRASH CUSHION, PERMANENT LOW MAINTENANCE AND SELF-RESTORING	EACH	2
618.0002.0000	SEEDING	LB	25
640.0001.0000	MOBILIZATION AND DEMOBILIZATION	LS	ALL REQ'D
641.0001.0000	EROSION, SEDIMENT, AND POLLUTION CONTROL ADMINISTRATION	LS	ALL REQ'D
641.0003.0000	TEMPORARY EROSION, SEDIMENT AND POLLUTION CONTROL	LS	ALL REQ'D
641.0006.0000	WITHHOLDING	CS	ALL REQ'D
641.0007.0000	SWPPP MANAGER	LS	ALL REQ'D
642.0001.0000	CONSTRUCTION SURVEYING	LS	ALL REQ'D
642.0003.0000	THREE PERSON SURVEY PARTY	HR	10
643.0002.0000	TRAFFIC MAINTENANCE	LS	ALL REQ'D
643.0023.0000	TRAFFIC PRICE ADJUSTMENT	CS	ALL REQ'D
643.0025.0000	TRAFFIC CONTROL	CS	ALL REQ'D
643.0032.0000	FLAGGING	CS	ALL REQ'D
644.0001.0000	FIELD OFFICE	LS	ALL REQ'D
644.2004.0000	ENGINEERING COMMUNICATIONS	CS	ALL REQ'D
644.2007.0000	VEHICLE (LT/SUV)	EA	2
645.0001.0000	TRAINING PROGRAM, _ TRAINEE/APPRENTICE	LH	500
646.0001.0000	CPM SCHEDULING	LS	ALL REQ'D
682.2000.0000	VAC-TRUCK POTHOLE	CS	ALL REQ'D

TABLE OF ESTIMATING FACTORS		
ITEM NO.	DESCRIPTION	ESTIMATING FACTOR
203.0006.000A	BORROW, TYPE A	144 LB/CF
301.0001.00D1	AGGREGATE BASE COURSE, GRADING D-1	144 LB/CF
401.0001.002A	HMA, TYPE II; CLASS A	151 LB/CF
401.0004.5228	ASPHALT BINDER, GRADE PG 52-28	5.3% WEIGHT OF 401.0001.002A HMA, TYPE II; CLASS A
618.0003.0000	WATER FOR SEEDING	1 MGAL/MSF

**GENERAL GUARDRAIL NOTES:**

- BEGIN AND END STATIONS GIVEN INCLUDE END TREATMENTS.
- PAY ITEM TOTALS AND LINEAR FEET FOR ITEMS 606.0001.0000 AND 606.0006.0000 W-BEAM GUARDRAIL RUNS DO NOT INCLUDE END TERMINAL LENGTHS. EXISTING END TERMINAL REMOVAL WILL NOT BE MEASURED AND IS SUBSIDIARY TO 606.0006.0000.
- FOR PARALLEL GUARDRAIL TERMINALS, CONSTRUCT THE GUARDRAIL TERMINAL WIDENING IN ACCORDANCE WITH THE "ALTERNATE DETAIL" ON STANDARD DRAWING G-20.12 THE END OFFSET (X) SHALL BE 2 FEET.
- IN ADDITION TO THE GUARDRAIL REFLECTORS, INSTALL GUARDRAIL FLEXIBLE DELINEATORS AS SHOWN ON STANDARD DRAWING G-00.05, SHEET 5.
- THE 'EXTEND GUARDRAIL PAST EXISTING TERMINAL' COLUMN IN THE 'GUARDRAIL SUMMARY' TABLES GIVES THE MEASUREMENT IN LINEAR FEET FROM EXISTING TERMINAL TO PROPOSED TERMINAL. THESE GUARDRAIL EXTENSION LENGTHS ARE ACCOUNTED FOR IN PAY ITEM W-BEAM GUARDRAIL 606.0001.0000.
- COORDINATE GUARDRAIL POST INSTALLATIONS WITH EXISTING CULVERT LOCATIONS. ADJUST LOCATIONS AS NEEDED TO ENSURE POSTS DO NOT PIERCE CULVERT.
- STAKE EXISTING END TERMINAL LOCATIONS AND BATTER BOARD LIMITS BEFORE REMOVING GUARDRAIL.
- GUARDRAIL OFFSET SHALL BE STAKED IN THE FIELD AND APPROVED BY THE ENGINEER.
- STATIONING MAY BE ADJUSTED BY THE ENGINEER.
- UPON REMOVAL OF THE OLD POSTS, OLD HOLES CREATED BY THE POST REMOVAL SHALL BE FILLED AND COMPACTED.
- VOIDS CREATED AROUND NEW POSTS DURING INSTALLATION SHALL BE FILLED AND COMPACTED. THIS WORK IS SUBSIDIARY TO PAY ITEMS W-BEAM GUARDRAIL 606.0001.0000.

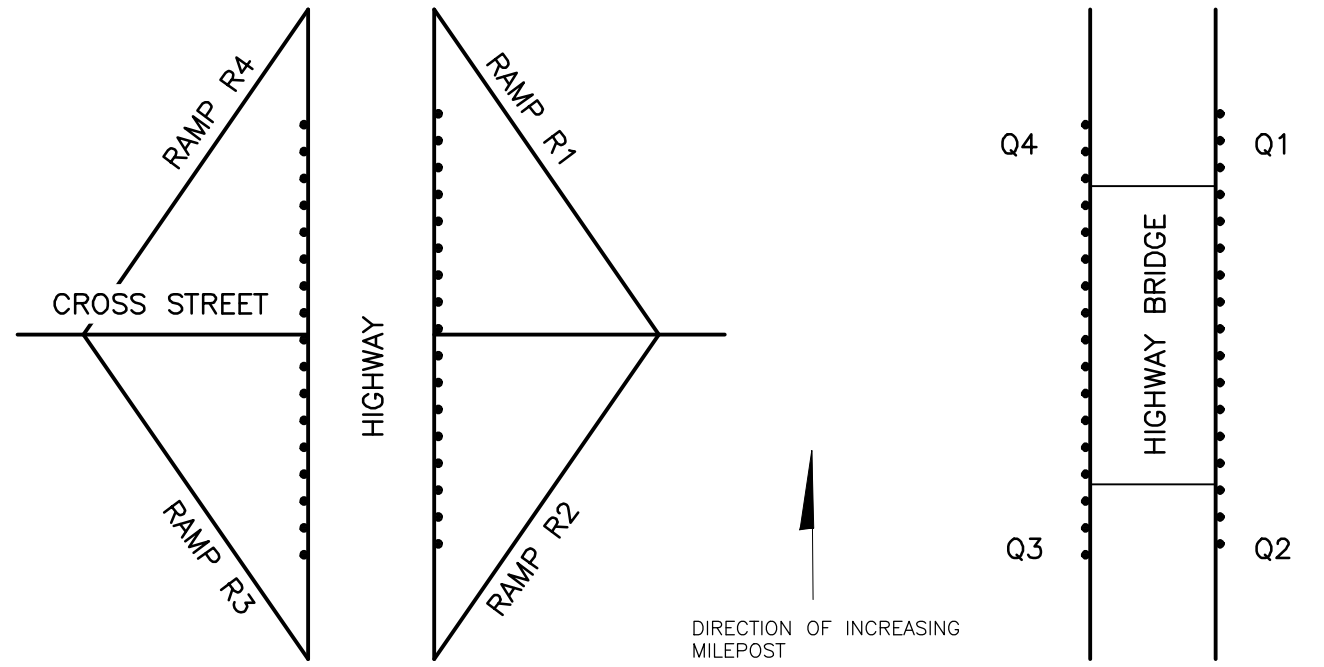

**RAMP AND BRIDGE LOCATION INDICATOR**  
SEE D SHEET SUMMARY TABLES

STATE OF ALASKA  
DEPARTMENT OF TRANSPORTATION  
AND PUBLIC FACILITIES

**HSIP: CR GUARDRAIL INVENTORY  
AND UPGRADE**

ESTIMATE OF QUANTITIES

**DRAFT**  
MARCH, 4 2022

PLANS DEVELOPED BY:  
LOUNSBURY & ASSOCIATES INC.

PLANS DEVELOPED BY: LOUNSBURY & ASSOCIATES ADDRESS: 3230 C ST., SUITE 201, ANCHORAGE AK 99503 PHONE: (907) 272-5451 DATE/TIME: 3/4/2022 1:53 PM CERTIFICATE OF AUTHORIZATION NUMBER: AECC391 FILE ID: \P\W\SE\FILE\DWG\04400\PL-20-001 D SHEETS ANC.DWG

DU DRAFTED JT CHECKED SA DESIGNED

NO.	DATE	REVISION	STATE	PROJECT DESIGNATION	YEAR	SHEET NO.	TOTAL SHEETS
			ALASKA	0001665/CFHWY00564	2022	D1	D6

ROAD	APPROX. BEGIN MPT	APPROX. END MPT	LOCATION	OFFSET SIDE	606.0006.0000	606.0001.0000	606.0009.0000	606.0013.0000	606.0014.0000	606.0016.0000	606.2007.000C	EXTEND GUARDRAIL PAST EXISTING END TERMINAL		CASE	REMARKS
					REMOVE GUARDRAIL (FT)	GUARDRAIL (FT)	SHORT RADIUS GUARDRAIL (EACH)	PARALLEL GUARDRAIL TERMINAL (EACH)	BURIED IN BACKSLOPE GUARDRAIL TERMINAL (EACH)	TRANSITION RAIL (EACH)	CRASH CUSHION (EACH)	DIRECTION	LENGTH (FT)		
C ST.	6.1	6.1	ML	LT	264	262.5								3	
GLENN HWY	0.0	0.2	ML-SB	MEDIAN	1056	1050.0		2						3	
GLENN HWY	0.1	0.2	ML-SB	LT	166	162.5		2						3	
GLENN HWY	0.4	0.6	ML-NB	RT	1056	1050.0		1		1				3	CONTINUES ONTO R2
GLENN HWY	0.4	0.6	ML-SB	LT	804	800.0		2						3	
GLENN HWY	0.5	0.8		RT	1228	1225.0		1			1			3	
GLENN HWY	0.7	0.7	R1	RT	264	262.5		1		1				3	
GLENN HWY	0.7	0.8	R1	RT	528	525.0		1		1				3	
GLENN HWY	0.7	0.7	R4	LT				1							REPLACE OPPOSING TERMINAL
GLENN HWY	0.7	0.8	ML-SB	LT	415	412.5		2						3	
GLENN HWY	0.8	0.8	ML-SB	LT				1							CONTINUES ONTO R4
GLENN HWY	0.9	1.3		LT	2112	2262.5		1				APPROACHING	150	3	
GLENN HWY	1.6	1.7	R2	RT	528	525.0		1						3	REPLACE APPROACHING TERMINAL
GLENN HWY	1.6	1.7	R2	LT	528	525.0				1				3	
GLENN HWY	1.7	1.8	ML-SB	MEDIAN				1						3	REPLACE APPROACHING TERMINAL
GLENN HWY	1.7	1.7	ML-NB	RT	264	262.5			1	1				3	
GLENN HWY	1.7	1.7	R4	MEDIAN	264	262.5			1	1				3	CONTINUES ONTO ML-SB
GLENN HWY	1.7	1.8	R1	RT	528	525.0		2						3	
GLENN HWY	2.8	3.2		RT	2112	2112.5		1						5	REPLACE OPPOSING TERMINAL
GLENN HWY	3.2	3.3	ML-SB	MEDIAN				1							REPLACE OPPOSING TERMINAL
GLENN HWY	3.6	3.9		RT	1584	1587.5		1						3	REPLACE OPPOSING TERMINAL
GLENN HWY	4.7	4.8		RT				1		1					
GLENN HWY	4.7	4.8		LT	15	12.5		1		1				3	
GLENN HWY	4.8	4.9		LT	528	525.0		1		1				3	
GLENN HWY	4.8	4.8		MEDIAN							1				
GLENN HWY	4.8	4.8		RT				1		1					
GLENN HWY	5.4	5.5		RT	528	525.0		2						3	
GLENN HWY	6.3	6.3	ML-NB	MEDIAN				2							
GLENN HWY	6.3	6.3	ML-NB	RT	79	262.5		2				APPROACHING	187.5	3	
GLENN HWY	6.3	6.4	ML-SB	MEDIAN	528	525.0		2						3	
GLENN HWY	9.0	9.1		RT	528	625.0		2				APPROACHING	100	3	
GLENN HWY	9.4	9.5		RT	172	250.0		2				APPROACHING	75	3	
GLENN HWY	9.7	10.0		LT	1150	1362.5		2				APPROACHING	212.5	3	
GLENN HWY	10.1	10.2	R3	LT	575	725.0		1				OPPOSING	200	5	
GLENN HWY	10.2	10.4	ML-NB	MEDIAN				1							REPLACE OPPOSING TERMINAL
GLENN HWY	10.2	10.4	ML-NB	RT	1056	1050.0		1						5	REPLACE OPPOSING TERMINAL

STATE OF ALASKA  
DEPARTMENT OF TRANSPORTATION  
AND PUBLIC FACILITIES

**HSIP: CR GUARDRAIL INVENTORY  
AND UPGRADE**

SUMMARY TABLES

**DRAFT  
MARCH, 4 2022**

PLANS DEVELOPED BY:  
LOUNSBURY & ASSOCIATES INC.

PLANS DEVELOPED BY: LOUNSBURY & ASSOCIATES ADDRESS: 3230 C ST., SUITE 201, ANCHORAGE AK 99503 PHONE: (907) 272-5451 DATE/TIME: 3/4/2022 1:53 PM CERTIFICATE OF AUTHORIZATION NUMBER: AECC391 FILE ID: \P\W\B\FILE\DWG\04400\PL-20-001 D SHEETS ANC.DWG

DRAFTED  
 CHECKED  
 DESIGNED  
 LAYOUT

NO.	DATE	REVISION	STATE	PROJECT DESIGNATION	YEAR	SHEET NO.	TOTAL SHEETS
			ALASKA	0001665/CFHWY00564	2022	D2	D6

ROAD	APPROX. BEGIN MPT	APPROX. END MPT	LOCATION	OFFSET SIDE	606.0006.0000	606.0001.0000	606.0009.0000	606.0013.0000	606.0014.0000	606.0016.0000	606.2007.000C	EXTEND GUARDRAIL PAST EXISTING END TERMINAL		CASE	REMARKS
					REMOVE GUARDRAIL (FT)	GUARDRAIL (FT)	SHORT RADIUS GUARDRAIL (EACH)	PARALLEL GUARDRAIL TERMINAL (EACH)	BURIED IN BACKSLOPE GUARDRAIL TERMINAL (EACH)	TRANSITION RAIL (EACH)	CRASH CUSHION (EACH)	DIRECTION	LENGTH (FT)		
GLENN HWY	12.0	12.1	ML-NB	RT	528	525.0		2						3	
GLENN HWY	12.1	12.1	R2	RT	264	262.5				1				3	
GLENN HWY	12.1	12.6		RT	2640	2637.5		1		1				5	
GLENN HWY	12.6	12.7		RT				1							REPLACE OPPOSING TERMINAL
GLENN HWY	12.7	12.8		LT	390	475.0		2				APPROACHING	87.5	3	
GLENN HWY	13.8	14.0	R2	RT	900	900.0		2						3	
GLENN HWY	13.8	14.0	R2	LT	1056	1050.0		1		1				3	
GLENN HWY	14.0	14.0	R3	RT	264	262.5		1		1				3	
GLENN HWY	14.0	14.0	R3	LT	40	37.5		2						3	
GLENN HWY	14.0	14.7	R1	RT	3696	3700.0		2						3	CONTINUES ONTO ML-NB
GLENN HWY	14.0	14.1	R1	LT	528	525.0		1		1				3	
GLENN HWY	14.0	14.1	R4	RT	528	525.0		1						3	
GLENN HWY	14.0	14.1	ML-SB	LT	510	512.5		2						3	
GLENN HWY	14.0	14.2	R4	LT	1056	1050.0		1						3	
GLENN HWY	14.4	14.7		MEDIAN	1584	1587.5		2						3	
GLENN HWY	14.9	15.2		RT	1465	1637.5		2				APPROACHING	175	3	
GLENN HWY	15.3	15.5		RT	790	787.5		2						4	
GLENN HWY	15.5	15.5		LT	140	312.5		2				APPROACHING	125	3	REMOVE APPROACHING TERMINAL AND EXTEND GUARDRAIL TO CONNECT WITH TERMINAL AT MPT 15.6
GLENN HWY	15.6	15.9		LT	1790	1837.5		2						5	REMOVE OPPOSING TERMINAL
GLENN HWY	15.7	16.0	ML-SB	LT	1584	1587.5		1		1				3	
GLENN HWY	15.7	15.8	R3	RT	528	525.0		1						5	REPLACE OPPOSING TERMINAL
GLENN HWY	15.9	16.0	ML-NB	MEDIAN	528	525.0		1						3	
GLENN HWY	15.9	16.0	ML-SB	MEDIAN	528	525.0		1						3	
GLENN HWY	15.9	16.0	ML-NB	RT	528	525.0								3	
GLENN HWY	16.0	16.1	ML-NB	MEDIAN	528	525.0		1		1				3	
GLENN HWY	16.0	16.1	ML-SB	MEDIAN	528	525.0				1				3	
GLENN HWY	16.0	16.0	ML-NB	RT	264	262.5		1		1				3	
GLENN HWY	16.0	16.1	ML-SB	LT	528	525.0		1		1				3	
GLENN HWY	16.1	16.3	R4	LT	1056	1050.0		2						5	
GLENN HWY	16.4	16.7		LT	1369	1425.0		2				APPROACHING	50	3	
GLENN HWY	17.3	17.8		LT	2507	2787.5		2				APPROACHING	275	3	

**DRAFT**  
MARCH, 4 2022

STATE OF ALASKA  
DEPARTMENT OF TRANSPORTATION  
AND PUBLIC FACILITIES

**HSIP: CR GUARDRAIL INVENTORY  
AND UPGRADE**

SUMMARY TABLES

PLANS DEVELOPED BY:  
LOUNSBURY & ASSOCIATES, INC.

PLANS DEVELOPED BY: LOUNSBURY & ASSOCIATES ADDRESS: 3230 C ST., SUITE 201, ANCHORAGE AK 99503 PHONE: (907) 272-5451 DATE/TIME: 3/4/2022 1:53 PM CERTIFICATE OF AUTHORIZATION NUMBER: AECC391 FILE ID: \P\W\B\FILE\DWG\04400\PL-20-001 D SHEETS ANC.DWG

SA [DESIGNED] JT [DRAFTED] DU

NO.	DATE	REVISION	STATE	PROJECT DESIGNATION	YEAR	SHEET NO.	TOTAL SHEETS
			ALASKA	0001665/CFHWY00564	2022	D3	D6

ROAD	APPROX. BEGIN MPT	APPROX. END MPT	LOCATION	OFFSET SIDE	606.0006.0000	606.0001.0000	606.0009.0000	606.0013.0000	606.0014.0000	606.0016.0000	606.2007.000C	EXTEND GUARDRAIL PAST EXISTING END TERMINAL		CASE	REMARKS
					REMOVE GUARDRAIL (FT)	GUARDRAIL (FT)	SHORT RADIUS GUARDRAIL (EACH)	PARALLEL GUARDRAIL TERMINAL (EACH)	BURIED IN BACKSLOPE GUARDRAIL TERMINAL (EACH)	TRANSITION RAIL (EACH)	CRASH CUSHION (EACH)	DIRECTION	LENGTH (FT)		
GLENN HWY	19.2	19.3	R2	LT	398	400.0		2						3	
GLENN HWY	19.3	19.3	R3	LT	315	312.5		2						3	
GLENN HWY	19.3	19.4	R3	RT	528	525.0		1		1				3	
GLENN HWY	19.4	19.5	R4	RT	310	312.5		2						3	
GLENN HWY	19.5	19.6	R1	RT	164	250.0		2				OPPOSING	35	3	CONNECTS TO ML-NB REMOVE OPPOSING TERMINAL AND EXTEND GUARDRAIL TO CONNECT WITH TERMINAL AT MPT 19.6
GLENN HWY	19.6	19.7	Q2	RT	528	525.0		1		1				3	REMOVE APPROACHING TERMINAL
GLENN HWY	19.6	19.7	Q3	LT	528	525.0		1						3	
GLENN HWY	19.6	19.7	Q2	MEDIAN	528	525.0		1						3	
GLENN HWY	19.7	19.7	Q3	MEDIAN				1							
GLENN HWY	19.8	19.8	Q1	MEDIAN				1		1					
GLENN HWY	19.8	19.8	Q4	MEDIAN	264	262.5		1		1				3	
GLENN HWY	19.8	19.8	Q4	LT	264	262.5								3	
GLENN HWY	19.8	19.8	Q1	RT				1							
GLENN HWY	20.3	20.4	Q2	MEDIAN	528	525.0								3	
GLENN HWY	20.3	20.4	Q3	LT	528	525.0		1						3	
GLENN HWY	20.3	20.4	Q2	RT	528	525.0		1						4	
GLENN HWY	20.4	20.4	Q1	MEDIAN				1							
GLENN HWY	20.4	20.4	Q3	MEDIAN				1							
GLENN HWY	20.4	20.5	Q4	MEDIAN	528	525.0		1						3	
GLENN HWY	20.4	20.5	Q1	RT				1							
GLENN HWY	20.4	20.5	Q4	LT	264	262.5		1						3	
GLENN HWY	21.2	21.2	ML-NB	RT	264	337.5		2				APPROACHING	75	3	CONTINUES ONTO R2
GLENN HWY	21.3	21.4	ML-NB	MEDIAN	528	525.0		2						5	
GLENN HWY	21.4	21.5	ML-SB	MEDIAN	528	525.0		2						3	
GLENN HWY	21.8	22.0		RT	629	762.5		2				APPROACHING	137.5	5	
GLENN HWY	22.6	22.7	ML-NB	RT	528	525.0		1		1		APPROACHING	12.5	3	
GLENN HWY	22.7	22.7	ML-NB	MEDIAN				1							
GLENN HWY	22.7	22.8	ML-NB	RT	528	525.0		1						3	
GLENN HWY	23.1	23.2		RT	465	525.0		2				APPROACHING	62.5	3	
GLENN HWY	23.1	23.3		LT	601	875.0		2				APPROACHING	275	3	
GLENN HWY	23.9	24.1		LT	1056	1050.0		1		1				3	

**DRAFT**  
MARCH, 4 2022

STATE OF ALASKA  
DEPARTMENT OF TRANSPORTATION  
AND PUBLIC FACILITIES

**HSIP: CR GUARDRAIL INVENTORY  
AND UPGRADE**

SUMMARY TABLES

PLANS DEVELOPED BY:  
LOUNSBURY & ASSOCIATES INC.



PLANS DEVELOPED BY: LOUNSBURY & ASSOCIATES ADDRESS: 3230 C ST., SUITE 201, ANCHORAGE AK 99503 PHONE: (907) 272-5451 CERTIFICATE OF AUTHORIZATION NUMBER: AECC391  
 FILE ID: \P\W\B\FILE\DWG\04400\PL-20-001 D SHEETS ANC.DWG DATE/TIME: 3/4/2022 1:53 PM LAYOUT: --- DESIGNED: SA CHECKED: JT DRAFTED: DU

NO.	DATE	REVISION	STATE	PROJECT DESIGNATION	YEAR	SHEET NO.	TOTAL SHEETS
			ALASKA	0001665/CFHWY00564	2022	D4	D6

ROAD	APPROX. BEGIN MPT	APPROX. END MPT	LOCATION	OFFSET SIDE	606.0006.0000	606.0001.0000	606.0009.0000	606.0013.0000	606.0014.0000	606.0016.0000	606.2007.000C	EXTEND GUARDRAIL PAST EXISTING END TERMINAL		CASE	REMARKS
					REMOVE GUARDRAIL (FT)	GUARDRAIL (FT)	SHORT RADIUS GUARDRAIL (EACH)	PARALLEL GUARDRAIL TERMINAL (EACH)	BURIED IN BACKSLOPE GUARDRAIL TERMINAL (EACH)	TRANSITION RAIL (EACH)	CRASH CUSHION (EACH)	DIRECTION	LENGTH (FT)		
GLENN HWY	24.0	24.1	Q2	MEDIAN	528	525.0		1						3	
GLENN HWY	24.0	24.1	Q2	RT	528	525.0		1		1				3	
GLENN HWY	24.1	24.2	Q4	LT		12.5		1				APPROACHING	12.5	3	
GLENN HWY	24.1	24.1	Q1	MEDIAN				1							
GLENN HWY	24.1	24.2	Q1	RT				1		1					
GLENN HWY	24.1	24.1	Q3	MEDIAN				1							
GLENN HWY	24.1	24.2	Q4	MEDIAN				1							
GLENN HWY	24.5	24.5		RT				1							REPLACE OPPOSING TERMINAL
GLENN HWY	24.7	24.7	ML-NB	MEDIAN	264	262.5		2						3	
GLENN HWY	24.7	24.7	R2	LT	264	262.5		1		1				3	
GLENN HWY	24.7	24.8	ML-SB	MEDIAN	528	525.0		2						3	
GLENN HWY	24.7	24.7	R3	RT	264	262.5		1		1				3	
GLENN HWY	24.7	24.7	R1	LT	264	262.5		1						3	
GLENN HWY	24.7	24.8	R4	RT	528	525.0		1		1				3	
GLENN HWY	24.9	25.2		LT	1584	1587.5		1						3	
GLENN HWY	25.0	25.2		RT	1056	1050.0		1				APPROACHING	187.5	3	
GLENN HWY	25.1	25.2		MEDIAN	528	525.0				1				3	
GLENN HWY	25.3	25.3		MEDIAN				1							
GLENN HWY	25.3	25.6		RT	1584	1587.5								5	
GLENN HWY	25.8	25.9		RT	528	525.0								3	
GLENN HWY	28.1	28.3	R2	RT				1							
GLENN HWY	28.1	28.3	R2	LT	1056	1050.0		1		1				3	
GLENN HWY	28.1	28.2	R3	RT	528	525.0		1		1				3	
GLENN HWY	28.1	28.2	R3	LT				1							
GLENN HWY	28.2	28.3		LT	528	525.0		2						3	
GLENN HWY	28.3	28.4	R1	LT	528	525.0								3	
GLENN HWY	28.3	28.5	R1	RT	1056	1050.0		1						3	REPLACE APPROACHING TERMINAL
GLENN HWY	28.6	28.7		LT	528	525.0								3	
GLENN HWY	28.7	28.7	Q2	MEDIAN	264	262.5		1						3	
GLENN HWY	28.7	28.7	Q3	MEDIAN	35	12.5				1				3	
GLENN HWY	29.0	29.2		RT	1056	1050.0								5	
GLENN HWY	29.0	29.0		MEDIAN						1					
GLENN HWY	29.0	29.1		MEDIAN	528	525.0								3	
GLENN HWY	29.0	29.3		LT	1584	1587.5								3	
GLENN HWY	29.4	29.6		LT				1							REPLACE OPPOSING TERMINAL
GLENN HWY	29.7	29.8		LT						1					
GLENN HWY	29.8	29.8		MEDIAN						1					
GLENN HWY	29.9	30.0		RT	528	525.0		1		1				3	
GLENN HWY	29.9	29.9		MEDIAN						1					
GLENN HWY	29.9	30.0		MEDIAN						1					
GLENN HWY	29.9	30.1		LT						1					

**DRAFT**  
MARCH, 4 2022

STATE OF ALASKA  
DEPARTMENT OF TRANSPORTATION  
AND PUBLIC FACILITIES

**HSIP: CR GUARDRAIL INVENTORY  
AND UPGRADE**

SUMMARY TABLES

PLANS DEVELOPED BY:  
LOUNSBURY & ASSOCIATES INC.

PLANS DEVELOPED BY: LOUNSBURY & ASSOCIATES ADDRESS: 3230 C ST., SUITE 201, ANCHORAGE AK 99503 PHONE: (907) 272-5451 DATE/TIME: 3/4/2022 1:55 PM CERTIFICATE OF AUTHORIZATION NUMBER: AECC391 FILE ID: \P\W\B\FILE\DWG\04400\PL-20-001 D SHEETS ANCH.DWG

DRAFTED  
 JT  
 SA  
 DESIGNED  
 LAYOUT  
 ---

NO.	DATE	REVISION	STATE	PROJECT DESIGNATION	YEAR	SHEET NO.	TOTAL SHEETS
			ALASKA	0001665/CFHWY00564	2022	D5	D6

ROAD	APPROX. BEGIN MPT	APPROX. END MPT	LOCATION	OFFSET SIDE	606.0006.0000	606.0001.0000	606.0009.0000	606.0013.0000	606.0014.0000	606.0016.0000	606.2007.000C	EXTEND GUARDRAIL PAST EXISTING END TERMINAL		CASE	REMARKS
					REMOVE GUARDRAIL (FT)	GUARDRAIL (FT)	SHORT RADIUS GUARDRAIL (EACH)	PARALLEL GUARDRAIL TERMINAL (EACH)	BURIED IN BACKSLOPE GUARDRAIL TERMINAL (EACH)	TRANSITION RAIL (EACH)	CRASH CUSHION (EACH)	DIRECTION	LENGTH (FT)		
GLENN HWY	30.3	30.4		RT						1					
GLENN HWY	30.4	30.4	Q2	MEDIAN	264	262.5		1		1				3	
GLENN HWY	30.4	30.4	Q3	MEDIAN						1					
GLENN HWY	30.6	30.7	Q1	MEDIAN						1					
GLENN HWY	30.6	30.7	Q4	MEDIAN						1					
INTERNATIONAL AIRPORT RD.	0.3	0.3		LT	264	262.5		1						3	REPLACE OPPOSING TERMINAL
INTERNATIONAL AIRPORT RD.	0.4	0.5		LT	134	137.5		2						3	
INTERNATIONAL AIRPORT RD.	1.6	1.7		RT	800	800.0		1						3	REPLACE OPPOSING TERMINAL
INTERNATIONAL AIRPORT RD.	1.6	1.7		LT	528	525.0		2						3	
INTERNATIONAL AIRPORT RD.	1.7	1.7		LT				1							
KNIK RIVER RD.	0.3	0.9		LT	3280	3275.0		2						3	
KNIK RIVER RD.	1.0	1.2		LT	1056	1050.0								5	
KNIK RIVER RD.	7.0	7.0		LT	264	262.5		2						3	
KNIK RIVER RD.	7.2	7.3		RT	528	525.0								3	
KNIK RIVER RD.	9.5	9.6		RT	528	525.0								3	
KNIK RIVER RD.	9.6	9.6		LT				1							REPLACE OPPOSING TERMINAL
KNIK RIVER RD.	11.0	11.0		LT		125.0		2				APPROACHING	125	3	
PORTAGE GLACIER RD.	1.9	2.1		LT				1							REPLACE OPPOSING TERMINAL
PORTAGE GLACIER RD.	2.7	2.9		LT	1000	1112.5		1				APPROACHING	112.5	3	
PORTAGE GLACIER RD.	3.1	3.1		LT				1							
PORTAGE GLACIER RD.	3.1	3.1		RT		225.0		1		1		APPROACHING	225	3	
PORTAGE GLACIER RD.	3.2	3.2		LT		112.5		1		1		APPROACHING	112.5	3	
PORTAGE GLACIER RD.	3.2	3.2		RT				1		1					
PORTAGE GLACIER RD.	3.5	3.8		LT	1380	1375.0								5	
PORTAGE GLACIER RD.	3.5	3.5		RT		125.0		1		1		APPROACHING	125	3	
PORTAGE GLACIER RD.	3.5	3.6		RT				1		1					

**DRAFT**  
MARCH, 4 2022

STATE OF ALASKA  
DEPARTMENT OF TRANSPORTATION  
AND PUBLIC FACILITIES

**HSIP: CR GUARDRAIL INVENTORY  
AND UPGRADE**

SUMMARY TABLES

PLANS DEVELOPED BY:  
LOUNSBURY & ASSOCIATES INC.

PLANS DEVELOPED BY: LOUNSBURY & ASSOCIATES ADDRESS: 3230 C ST., SUITE 201, ANCHORAGE AK 99503 PHONE: (907) 272-5451 DATE/TIME: 3/4/2022 1:53 PM  
 FILE ID: \\PWISEFILE\DWG\04400\PL-20-001 D SHEETS ANC.DWG  
 CERTIFICATE OF AUTHORIZATION NUMBER: AECC391  
 SA [DESIGNED] JT [DRAFTED] DU

NO.	DATE	REVISION	STATE	PROJECT DESIGNATION	YEAR	SHEET NO.	TOTAL SHEETS
			ALASKA	0001665/CFHWY00564	2022	D6	D6

ROAD	APPROX. BEGIN MPT	APPROX. END MPT	LOCATION	OFFSET SIDE	606.0006.0000	606.0001.0000	606.0009.0000	606.0013.0000	606.0014.0000	606.0016.0000	606.2007.000C	EXTEND GUARDRAIL PAST EXISTING END TERMINAL		CASE	REMARKS
					REMOVE GUARDRAIL (FT)	GUARDRAIL (FT)	SHORT RADIUS GUARDRAIL (EACH)	PARALLEL GUARDRAIL TERMINAL (EACH)	BURIED IN BACKSLOPE GUARDRAIL TERMINAL (EACH)	TRANSITION RAIL (EACH)	CRASH CUSHION (EACH)	DIRECTION	LENGTH (FT)		
PORTAGE GLACIER RD.	4.1	4.1	Q3	LT				1							
PORTAGE GLACIER RD.	4.1	4.1	Q4	LT		187.5		1		1		APPROACHING	187.5	3	
PORTAGE GLACIER RD.	4.1	4.1	Q2	RT		237.5		1				APPROACHING	237.5	5	
PORTAGE GLACIER RD.	4.1	4.1	Q1	RT				1							
SEWARD HWY	89.7	90.5		LT	4224	4225.0	1			1				3	
SEWARD HWY	90.4	90.6		RT	1275	1275.0		2						4	
SEWARD HWY	90.8	90.9		RT	100	100.0		2						3	
SEWARD HWY	90.6	91.6		LT	5280	5275.0	1							4	REPLACE OPPOSING TERMINAL
SEWARD HWY	91.6	92.0		LT	1875	1875.0	1	1						3	
SEWARD HWY	91.7	91.8		RT				1							REPLACE APPROACHING TERMINAL
SEWARD HWY	92.0	92.4		LT	1915	1912.5								3	
SEWARD HWY	92.4	93.2		LT	4224	4225.0	2							5	
SEWARD HWY	93.2	94.4		LT	6032	6037.5	2							3	
SEWARD HWY	94.4	95.1		LT	3696	3700.0	1							3	
SEWARD HWY	94.9	95.1		RT	1056	1050.0		1		1				3	
SEWARD HWY	95.1	95.2		LT	528	525.0		1		1				3	
SEWARD HWY	95.1	95.1		RT	264	262.5	1			1				3	
SEWARD HWY	97.8	98.0		LT	1056	1050.0								3	
SEWARD HWY	97.8	98.0		RT	1056	1050.0		1						3	
SEWARD HWY	98.1	98.3		LT	1056	1050.0								3	
SEWARD HWY	104.5	105.8		LT	6864	6862.5		1						5	REPLACE APPROACHING TERMINAL
SEWARD HWY	105.3	105.4		RT				1							REPLACE APPROACHING TERMINAL
SEWARD HWY	105.4	105.4		RT				1							REPLACE OPPOSING TERMINAL
TOTAL:					126,025.0	129,200.0	9	192	2	57	2				

**DRAFT**  
MARCH, 4 2022

STATE OF ALASKA  
DEPARTMENT OF TRANSPORTATION  
AND PUBLIC FACILITIES

**HSIP: CR GUARDRAIL INVENTORY  
AND UPGRADE**

SUMMARY TABLES

PLANS DEVELOPED BY:  
LOUNSBURY & ASSOCIATES INC.

PLANS DEVELOPED BY: LOUNSBURY & ASSOCIATES ADDRESS: 3230 C ST., SUITE 201, ANCHORAGE AK 99503  
 PHONE: (907) 272-5451 CERTIFICATE OF AUTHORIZATION NUMBER: AECC391  
 FILE ID: \\PWS\FILES\DWG\04\00\PL-20-001 G SHEETS\GLENN.DWG DATE/TIME: 3/4/2022 1:53 PM  
 DRAFTED: JC DESIGNED: SM CHECKED: JC LAYOUT:

NOTE:  
 THE LOCATION OF THE 30' LONG GRADING BREAK LINE IS OFFSET 19' FROM THE WIDENING EDGE OF PAVEMENT. MAINTAIN A 3:1 SLOPE FROM WIDENING EDGE OF PAVEMENT AND SHOULDER HINGE TO THE GRADING BREAK LINE. BEYOND THE BREAK LINE GRADE 2:1 TO MATCH EXISTING.

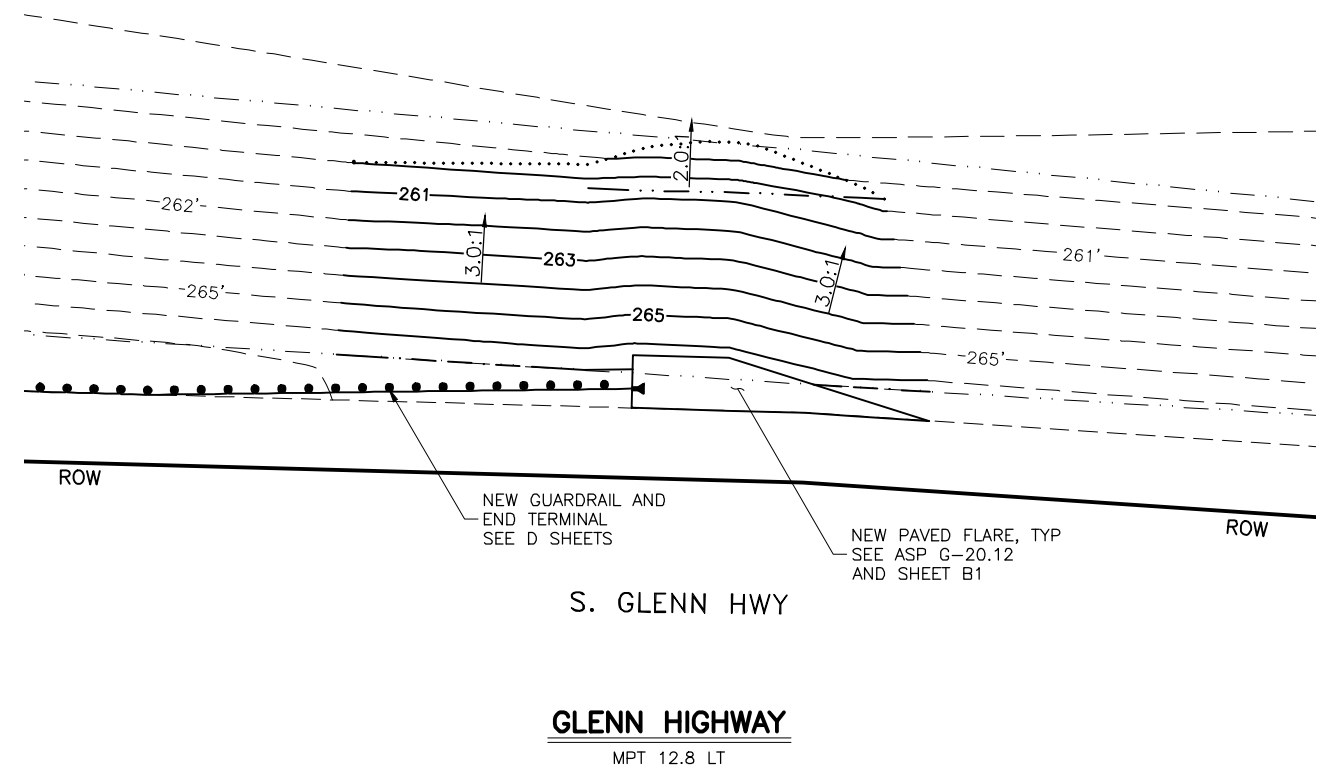

NOTE:  
 THE LOCATION OF THE 61' LONG DITCH LINE RE-GRADING STARTS AT THE EXISTING DITCH LINE APPROXIMATELY 19' OFFSET FROM END OF PROPOSED WIDENING. MAINTAIN A 4:1 FORESLOPE AND 5:1 BACKSLOPE FROM WIDENING EDGE OF PAVEMENT AND SHOULDER HINGE TO PROPOSED DITCH. GRADE TO DRAIN INTO EXISTING DITCH.

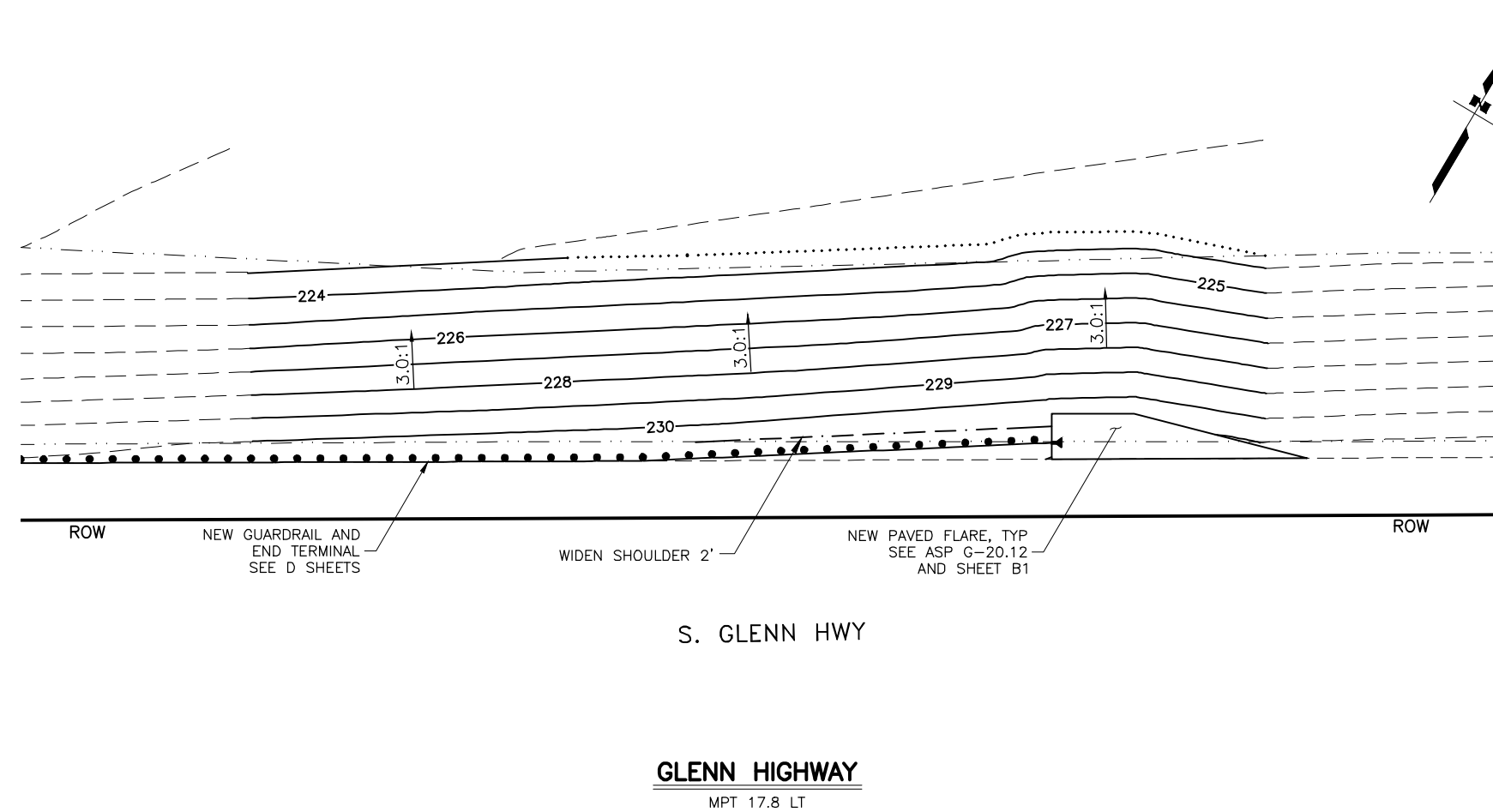
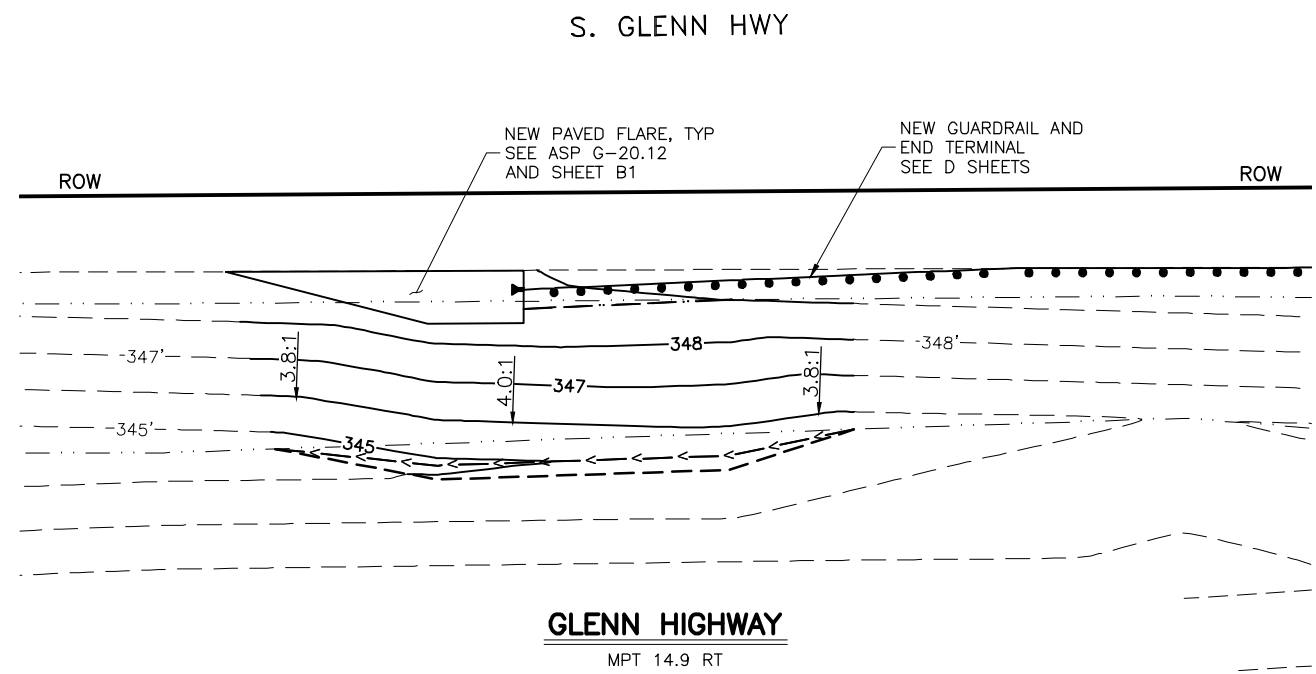

SHEET NO.	TOTAL SHEETS
G1	G3
STATE	YEAR
ALASKA	2022
PROJECT DESIGNATION	
001665/ CFHWY00564	
NO.	REVISION
DATE	
NO.	REVISION
DATE	
NO.	REVISION
DATE	

DRAFT  
 MARCH, 4 2022

PLANS DEVELOPED BY:  
 LOUNSBURY & ASSOCIATES INC.  
 STATE OF ALASKA  
 DEPARTMENT OF TRANSPORTATION  
 AND PUBLIC FACILITIES  
 HSIP: CR GUARDRAIL  
 INVENTORY AND UPGRADE  
 GLENN HIGHWAY  
 MPT 12.8 RT TO 21.2 RT

PLANS DEVELOPED BY: LOUNSBURY & ASSOCIATES ADDRESS: 3230 C ST., SUITE 201, ANCHORAGE AK 99503 PHONE: (907) 272-5451 CERTIFICATE OF AUTHORIZATION NUMBER: AECC391  
 FILE ID: \P\W\B\FILE\DWG\04\00\PL-20-001 G SHEETS PORTAGE.DWG DATE/TIME: 3/4/2022 1:53 PM [LAYOUT] [DESIGNED] [SM] [CHECKED] [JC] [DRAFTED] [DU]

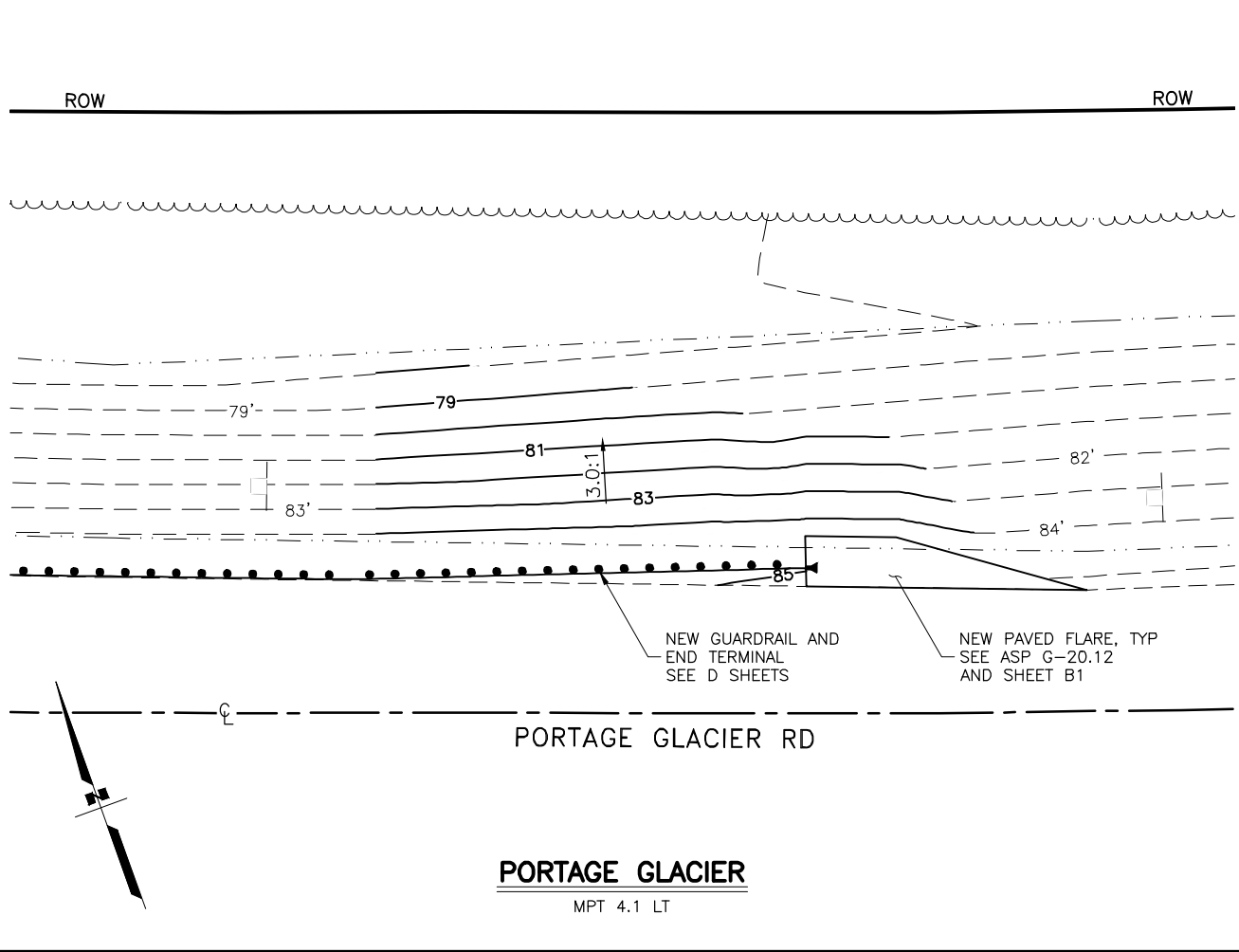
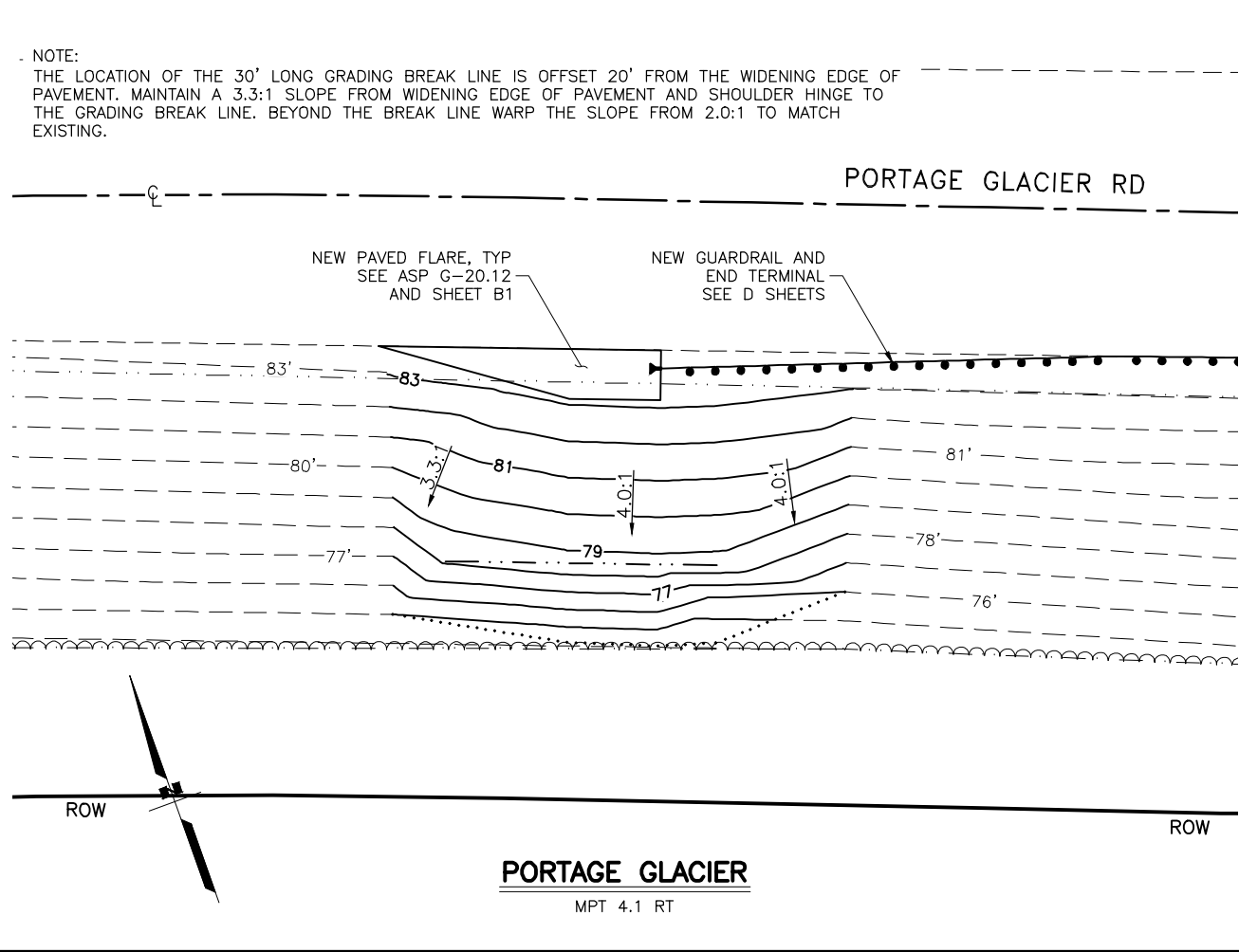
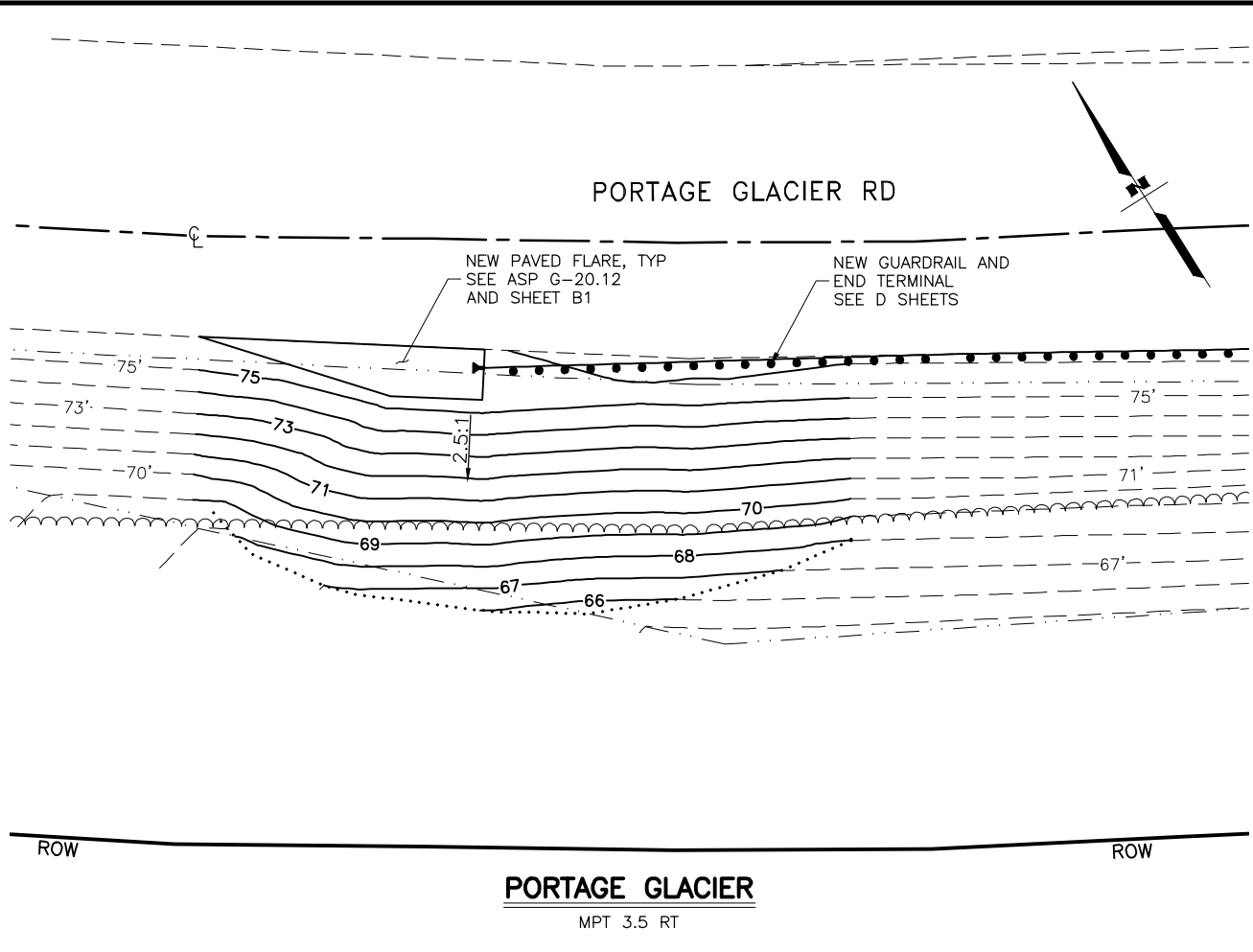
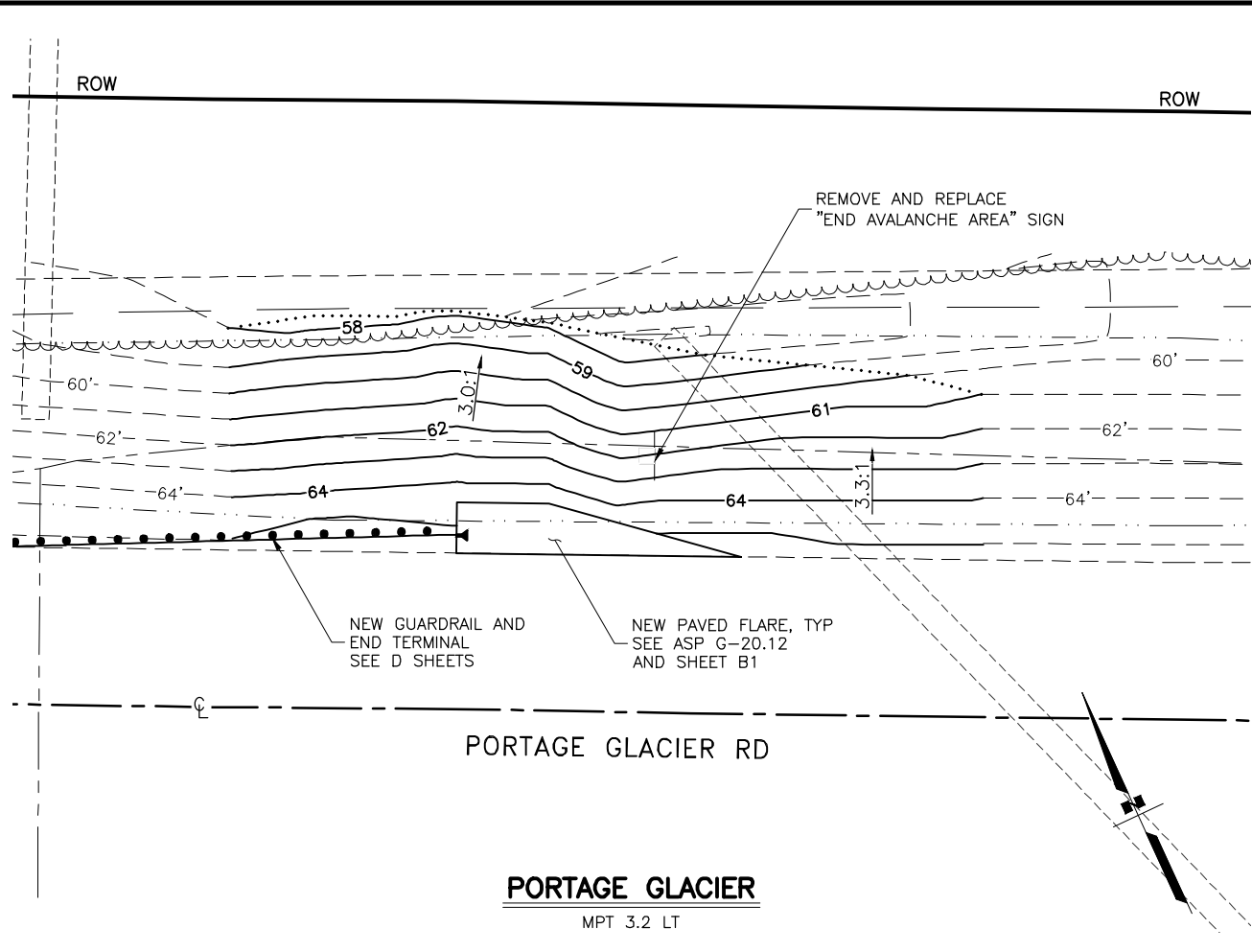

SHEET NO.	TOTAL SHEETS
G2	G3
STATE	YEAR
ALASKA	2022
PROJECT DESIGNATION	
001665/ CFHWY00564	
NO.	REVISION
DATE	
NO.	REVISION
DATE	
NO.	REVISION
DATE	

**PORTAGE GLACIER RD**  
 PORTAGE GLACIER  
 MPT 3.2 LT

**PORTAGE GLACIER RD**  
 PORTAGE GLACIER  
 MPT 3.5 RT

**PORTAGE GLACIER RD**  
 PORTAGE GLACIER  
 MPT 4.1 RT

**PORTAGE GLACIER RD**  
 PORTAGE GLACIER  
 MPT 4.1 LT

**DRAFT**  
 MARCH, 4 2022

PLANS DEVELOPED BY:  
 LOUNSBURY & ASSOCIATES INC.

STATE OF ALASKA  
 DEPARTMENT OF TRANSPORTATION  
 AND PUBLIC FACILITIES

HSIP: CR GUARDRAIL  
 INVENTORY AND UPGRADE

PORTAGE GLACIER  
 MPT 12.8 RT TO 21.2 RT

PLANS DEVELOPED BY: LOUNSBURY & ASSOCIATES ADDRESS: 3230 C ST., SUITE 201, ANCHORAGE AK 99503 PHONE: (907) 272-5451 DATE/TIME: 3/4/2022 1:53 PM CERTIFICATE OF AUTHORIZATION NUMBER: AECC391

FILE ID: \\PWISEFILE\DWG\0400\PL-20-001 G SHEETS KNIK.DWG

DESIGNED: SM CHECKED: JC DRAFTED: DU

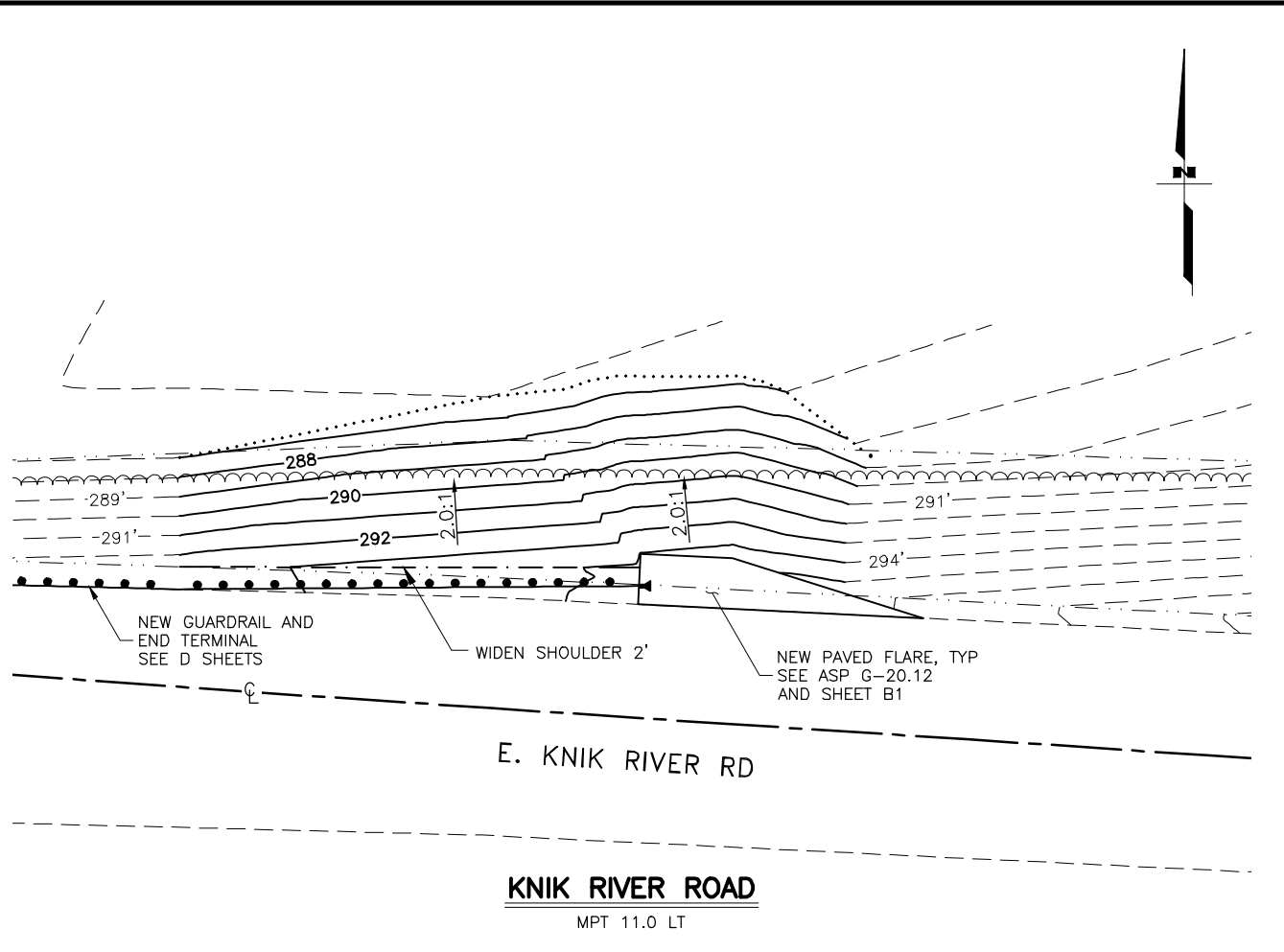

SHEET NO.	TOTAL SHEETS
G3	G3
STATE	YEAR
ALASKA	2022
PROJECT DESIGNATION	
001665/ CFHWY00564	
NO.	REVISION
DATE	
NO.	REVISION
DATE	
NO.	REVISION
DATE	

**DRAFT**  
MARCH, 4 2022

PLANS DEVELOPED BY:  
LOUNSBURY & ASSOCIATES INC.

STATE OF ALASKA  
DEPARTMENT OF TRANSPORTATION  
AND PUBLIC FACILITIES

HSIP: CR GUARDRAIL  
INVENTORY AND UPGRADE

**KNIK RIVER ROAD**  
MPT 11.0 LT