

ALTERNATIVE 1 - NO BUILD

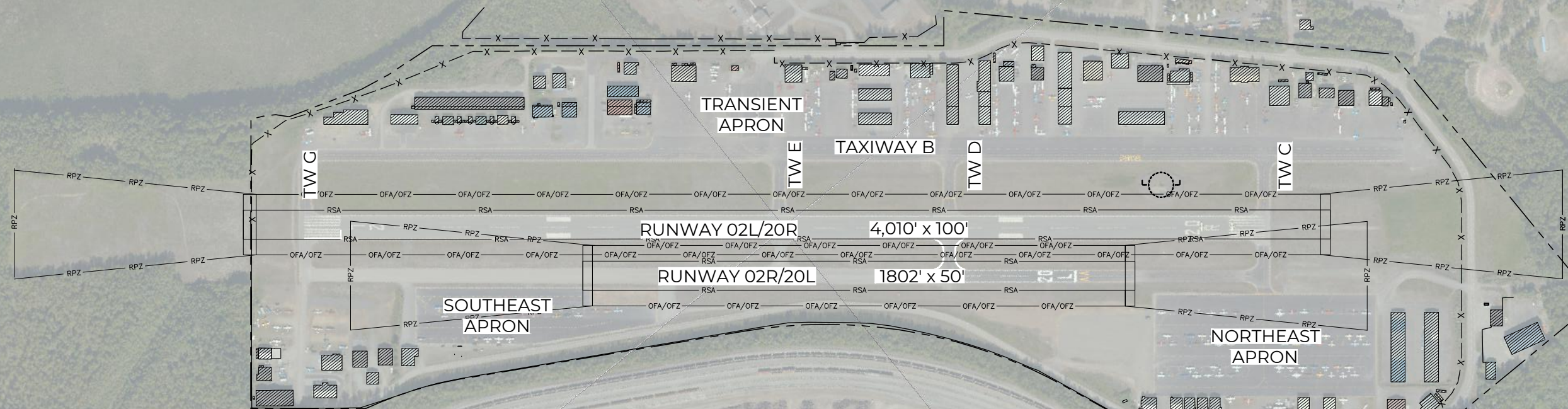

LEGEND

- RSA ——— RUNWAY SAFETY AREA
- OFA/OFZ ——— OBJECT FREE AREA/ZONE
- RPZ ——— RPZ ——— RUNWAY PROTECTION ZONE

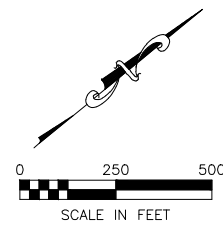

BIRCHWOOD AIRPORT MASTER PLAN EXHIBIT - ALTERNATIVE 1 DEPARTMENT OF TRANSPORTATION AND PUBLIC FACILITIES/CR BIRCHWOOD, ALASKA		
DATE: 11-7-2022	DRAWN BY: TA/TC	SHEET: 1
SCALE: 1" = 250'	CHECKED BY: MS	JOB NO.: 20-014



# ALTERNATIVE 2

- 1 ACQUIRE AIRPORT PROPERTY (APPROX. 61 ACRES)
- 2 RECONSTRUCT RUNWAY 02L/20R
- 3 RECONSTRUCT RUNWAY 02R/20L WITH SKI-PLANE TURNAROUNDS AND RENAME 02S/20S
- 4 REMOVE TAXIWAY A SEGMENTS; RE-GRADE AREA FOR EMERGENCY GLIDER LANDING OPERATIONS
- 5 RECONSTRUCT TAXIWAY A
- 6 CONSTRUCT TAXIWAY A EXTENSION
- 7 ACQUIRE AIRPORT PROPERTY (APPROX. 1.2 ACRES)
- 8 REMOVE EXISTING TAXIWAY D & CONSTRUCT NEW TAXIWAY D
- 9 REMOVE EXISTING TAXIWAY E
- 10 CONSTRUCT NEW TAXIWAY F
- 11 RECONSTRUCT EXISTING TAXIWAY G
- 12 CONSTRUCT NEW GRAVEL/SKI APRON (94 SMALL TIE-DOWNS; 10 LARGE TIE-DOWNS; 14 TRANSIENT TIE-DOWNS)
- 13 INSTALL ELECTRICAL OUTLETS AT NEW TIE-DOWN SPACES
- 14 NEW HANGAR LEASE LOT AREA
- 15 NEW T-HANGAR LEASE LOT AREA
- 16 EXPAND NORTHEAST APRON (25 SMALL TIE-DOWNS)
- 17 CONSTRUCT SUMMER AIRCRAFT TIE-DOWN AREA/WINTER SNOW STORAGE AREA (8 SMALL TIE-DOWNS)
- 18 DEVELOP NEW VEHICLE PARKING AREA WITH PORTABLE PUBLIC RESTROOM FACILITIES
- 19 CONSTRUCT ACCESS ROADS
- 20 REMOVE EXISTING FENCING
- 21 CONSTRUCT NEW PERIMETER FENCING
- 22 INSTALL NEW PAPI
- 23 PAVE TAXIWAY SHOULDER/APRON AREA TO LEASE LINES TO REDUCE FOD
- 24 RELOCATE WEATHER STATION
- 25 PROVIDE UNRESTRICTED ACCESS TO NEIGHBORING PROPERTY AND TRAIL SYSTEM
- 26 RE-ALIGN ACCESS ROAD OUTSIDE OF OFA/OFZ
- 27 INSTALL SUPPLEMENTAL WIND CONE

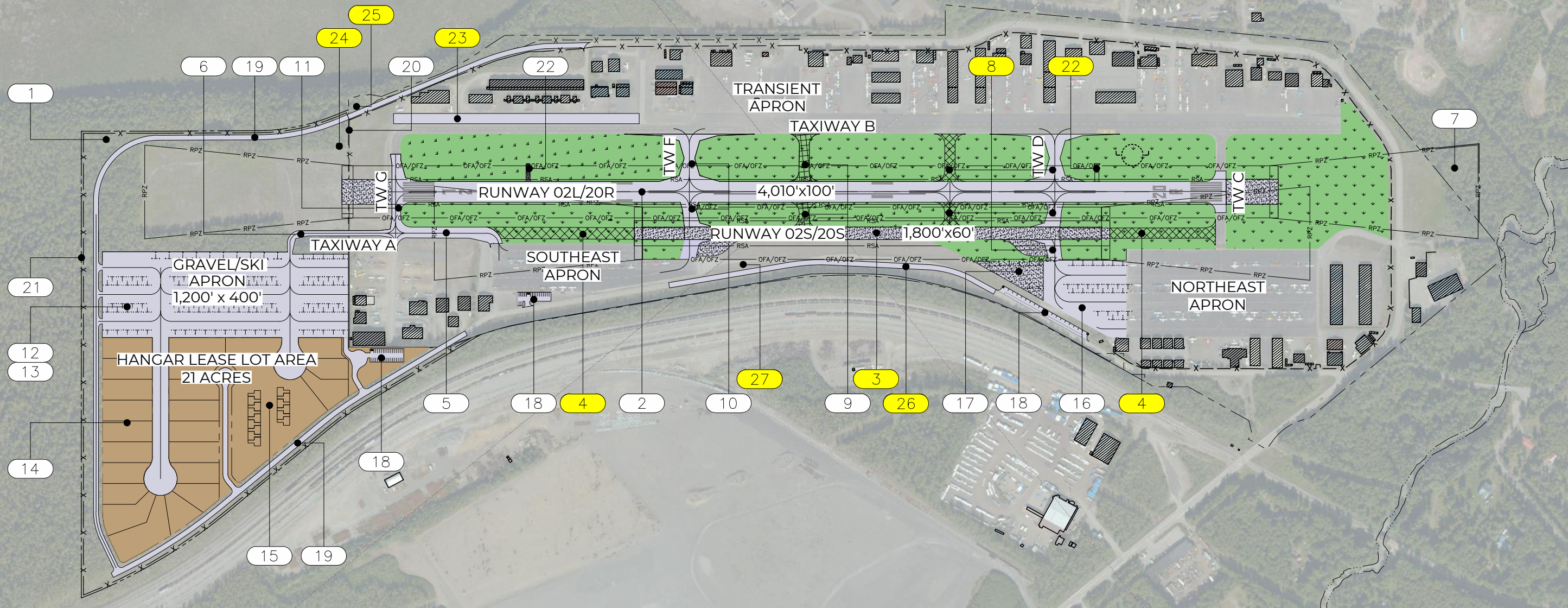

## LEGEND

- HANGAR DEVELOPMENT AREAS
- NEW GRASS AREA
- NEW PAVEMENT
- NEW GRAVEL SURFACE
- PARKING & PORTABLE PUBLIC RESTROOMS
- AIRCRAFT TIE-DOWN
- PROPOSED AIRPORT PROPERTY BOUNDARY
- NEW FENCE
- RUNWAY SAFETY AREA
- OBJECT FREE AREA/ZONE
- RUNWAY PROTECTION ZONE
- CHANGES COMPARED TO 11-7-2022
- X

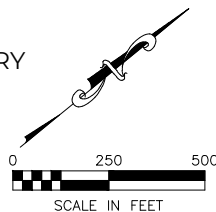

<b>BIRCHWOOD AIRPORT MASTER PLAN</b>		
<b>EXHIBIT - ALTERNATIVE 2</b>		
DEPARTMENT OF TRANSPORTATION AND PUBLIC FACILITIES/CR		
BIRCHWOOD, ALASKA		
DATE: 12-14-2022	DRAWN BY: TA/TC	SHEET: 2
SCALE: 1" = 250'	CHECKED BY: MS	JOB NO.: 20-014



# ALTERNATIVE 3

- |   |   |   |
|---|---|---|
| 1 ACQUIRE AIRPORT PROPERTY (APPROX. 61 ACRES)                                   | 12 RECONSTRUCT EXISTING TAXIWAY G   | 22 CONSTRUCT NEW PERIMETER FENCING  |
| 2 RECONSTRUCT RUNWAY 02L/20R  | 13 CONSTRUCT NEW APRON (62 SMALL TIE-DOWNS; 10 LARGE TIE-DOWNS; 14 TRANSIENT TIE-DOWNS) | 23 INSTALL NEW PAPI   |
| 3 CONSTRUCT NEW "SHOULDER" GRAVEL/SKI RUNWAY 02S/20S WITH SKI-PLANE TURNAROUNDS | 14 INSTALL ELECTRICAL OUTLETS AT TIE-DOWN SPACES  | 24 PAVE TAXIWAY SHOULDER/ APRON AREA TO LEASE LINES TO REDUCE FOD         |
| 4 REMOVE EXISTING RUNWAY 02R/20L  | 15 CONSTRUCT NEW HANGAR LEASE AREA  | 25 RELOCATE WEATHER STATION   |
| 5 RELOCATE AND RECONSTRUCT TAXIWAY A TO PROVIDE REQUIRED RUNWAY SEPARATION      | 16 CONSTRUCT NEW T-HANGAR LEASE AREA  | 26 PROVIDE UNRESTRICTED ACCESS FROM NEIGHBORING PROPERTY AND TRAIL SYSTEM |
| 6 CONSTRUCT TAXIWAY A EXTENSION   | 17 EXPAND NORTHEAST APRON (29 SMALL TIE-DOWNS)  | 27 INSTALL SUPPLEMENTAL WIND CONE   |
| 7 ACQUIRE AIRPORT PROPERTY (APPROX. 1.2 ACRES)                                  | 18 CONSTRUCT SUMMER AIRCRAFT TIE-DOWN AREA/WINTER SNOW STORAGE AREA (5 SMALL TIE-DOWNS) |   |
| 8 RECONSTRUCT TAXIWAY C   | 19 DEVELOP NEW VEHICLE PARKING AREA WITH PORTABLE PUBLIC RESTROOM FACILITIES            |   |
| 9 REMOVE PORTION OF EXISTING TAXIWAY D  | 20 CONSTRUCT ACCESS ROADS   |   |
| 10 RECONSTRUCT EXISTING TAXIWAY E   | 21 REMOVE EXISTING FENCE  |   |
| 11 CONSTRUCT NEW TAXIWAY F  |   |   |

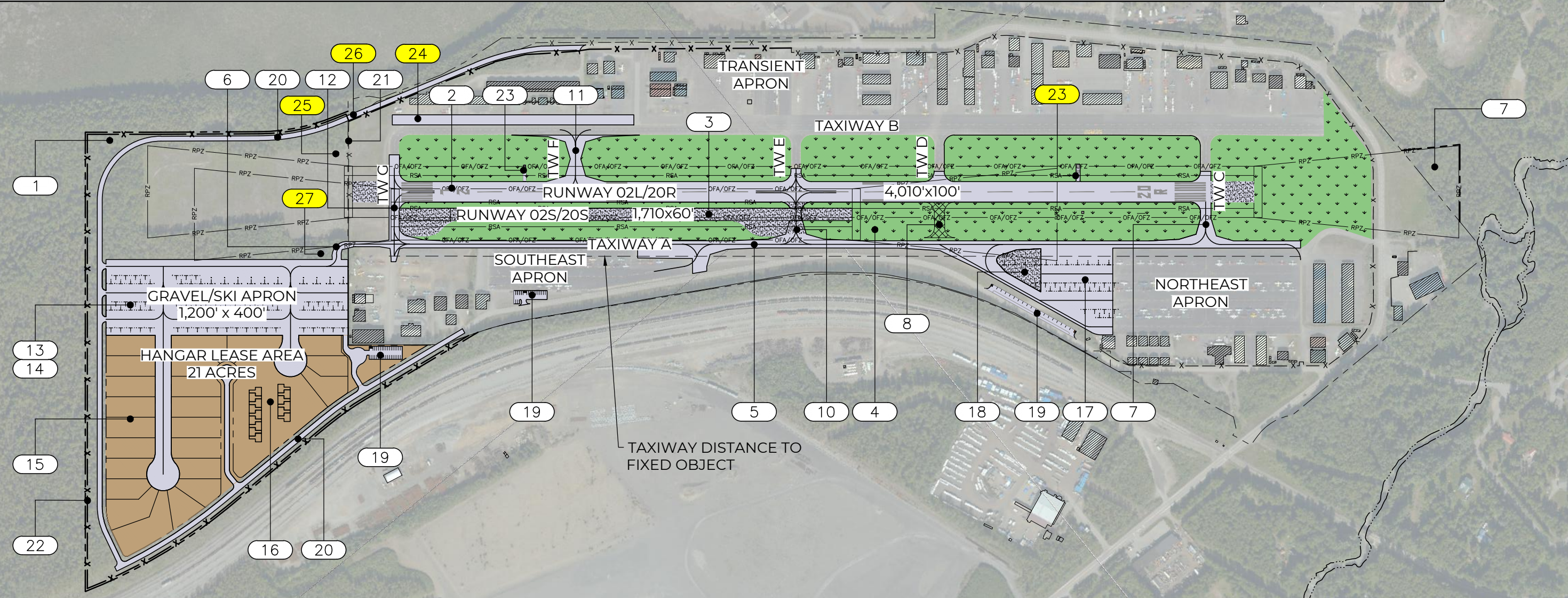

**LEGEND**

	HANGAR DEVELOPMENT AREAS		PROPOSED AIRPORT PROPERTY BOUNDARY
	NEW GRASS AREA		NEW FENCE
	NEW PAVEMENT		RUNWAY SAFETY AREA
	NEW GRAVEL SURFACE		OBJECT FREE AREA/ZONE
	PARKING & PORTABLE PUBLIC RESTROOMS		RUNWAY PROTECTION ZONE
	AIRCRAFT TIE-DOWN		CHANGES COMPARED TO 11-7-2022

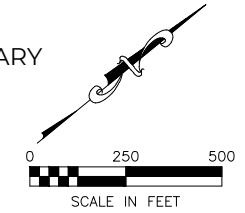

<b>BIRCHWOOD AIRPORT MASTER PLAN</b>		
<b>EXHIBIT - ALTERNATIVE 3</b>		
DEPARTMENT OF TRANSPORTATION AND PUBLIC FACILITIES/CR		
BIRCHWOOD, ALASKA		
DATE: 12-12-2022	DRAWN BY: TA/TC	SHEET: 3
SCALE: 1" = 250'	CHECKED BY: MS	JOB NO.: 20-014



# ALTERNATIVE 4

- |  |  |   |
|--|--|---|
| 1 ACQUIRE AIRPORT PROPERTY (APPROX. 175 ACRES)                                     | 11 INSTALL ELECTRIC OUTLETS AT NEW TIE-DOWNS   | 19 REMOVE EXISTING FENCE  |
| 2 RECONSTRUCT RUNWAY 02L/20R   | 12 NEW HANGAR LEASE LOT AREA   | 20 CONSTRUCT NEW PERIMETER FENCING                                  |
| 3 CONSTRUCT NEW GRAVEL/SKI RUNWAY 02S/20S  | 13 NEW T-HANGAR LEASE AREA   | 21 ACQUIRE AIRPORT PROPERTY (APPROX. 1.2 ACRES)                     |
| 4 REMOVE EXISTING RUNWAY 02R/20L   | 14 EXPAND NORTHEAST APRON (11 SMALL TIE-DOWNS)<br>(10 LARGE TIE-DOWNS)               | 22 CONSTRUCT NEW PAPI   |
| 5 RECONSTRUCT TAXIWAY A  | 15 EXPAND SOUTHEAST APRON  | 23 PAVE TAXIWAY SHOULDER/APRON AREA TO LEASE LINES<br>TO REDUCE FOD |
| 6 CONSTRUCT TAXIWAY A EXTENSION  | 16 CONSTRUCT SUMMER AIRCRAFT TIE-DOWN<br>AREA/WINTER SNOW STORAGE AREA (4 TIE-DOWNS) | 24 RELOCATE WEATHER STATION   |
| 7 RECONSTRUCT TAXIWAY C  | 17 DEVELOP NEW VEHICLE PARKING AREA WITH<br>PORTABLE PUBLIC RESTROOM FACILITIES      | 25 INSTALL SUPPLEMENTAL WIND CONE                                   |
| 8 CONSTRUCT NEW TAXIWAY F  | 18 CONSTRUCT ACCESS ROADS  |   |
| 9 CONSTRUCT NEW TAXIWAY S  |  |   |
| 10 CONSTRUCT NEW GRAVEL/SKI APRON (184 SMALL<br>TIE-DOWNS; 10 TRANSIENT TIE-DOWNS) |  |   |

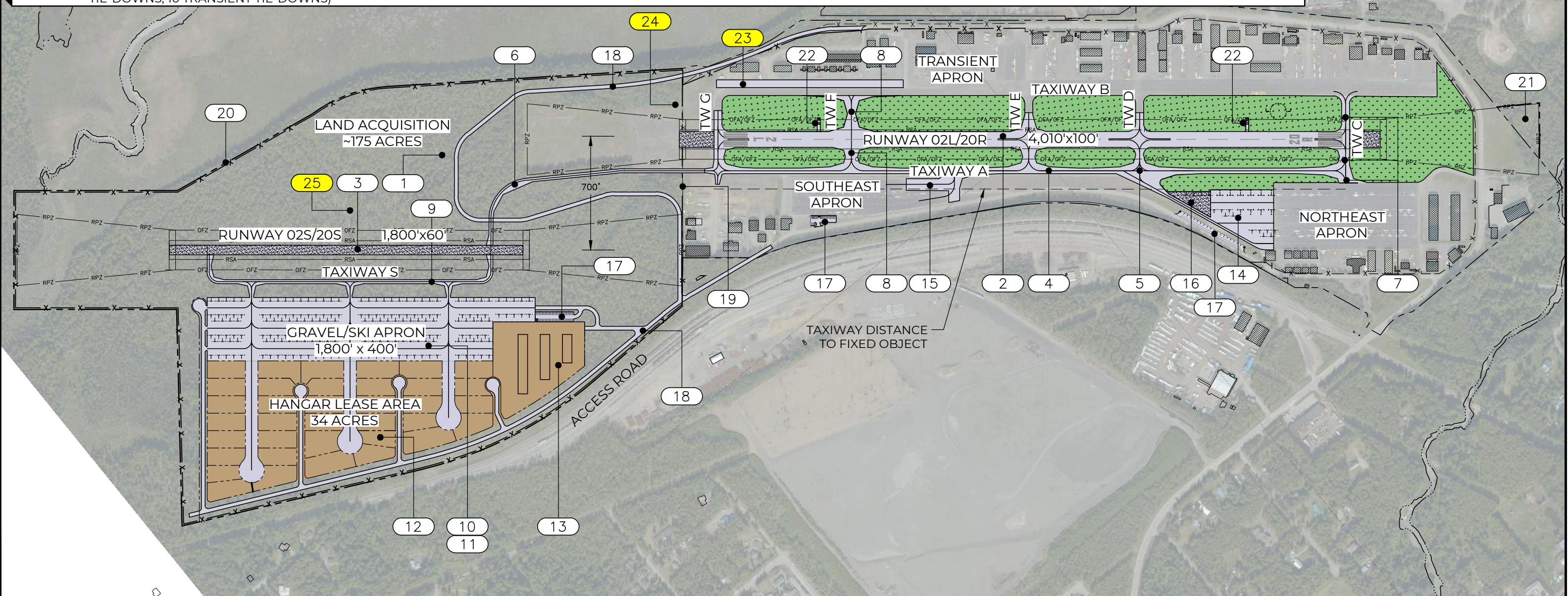

## LEGEND

- |                                     |                                    |
|-------------------------------------|------------------------------------|
| HANGAR DEVELOPMENT AREAS            | PROPOSED AIRPORT PROPERTY BOUNDARY |
| NEW GRASS AREA                      | NEW FENCE                          |
| NEW PAVEMENT                        | RUNWAY SAFETY AREA                 |
| NEW GRAVEL SURFACE                  | OBJECT FREE AREA/ZONE              |
| PARKING & PORTABLE PUBLIC RESTROOMS | RUNWAY PROTECTION ZONE             |
| AIRCRAFT TIE-DOWN                   | CHANGES COMPARED TO 11-7-2022      |

<b>BIRCHWOOD AIRPORT MASTER PLAN</b> <b>EXHIBIT - ALTERNATIVE 4</b> <b>DEPARTMENT OF TRANSPORTATION AND PUBLIC FACILITIES/CR</b> BIRCHWOOD, ALASKA		
DATE: 12-13-2022	DRAWN BY: TA/TC	SHEET: 4
SCALE: 1" = 300'	CHECKED BY: MS	JOB NO.: 20-014